

DRIVEWAY PERMIT APPLICATION

TO: THE UPSHUR COUNTY COMMISSIONERS COURT
COUNTY OF UPSHUR
GILMER, TEXAS

PRECINCT 4

DATE January 31, 2022

Formal notice is hereby given that Ray Settles, whose principal address is 103 Heather Lane Diana TX does hereby purpose to place a driveway culvert within the ROW of County Road North Mimosa. Proposed construction will begin, if approved, on or after the 15th day of February, 2022. I, Ray Settles, hereby attest that I have read the conditions set forth in this application and understand its contents. The culvert will be placed by County equipment and personnel. This is a new installation.

SIGNATURE: 
TELEPHONE: 720-878-7788

APPROVAL OF PERMIT APPLICATION

The Upshur County Commissioners Court offers no objection to the location on the right of way of your proposed driveway culvert for the address shown above. The proposed driveway structure will be a "x " culvert.

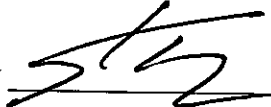
Recommended by 

APPROVED ON THIS _____ DAY OF _____, 20__.

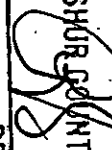
FILED
TERRI ROSS
COUNTY CLERK
2022 APR 14 PM 1:06
BY 
UPSHUR COUNTY, TX.
DEPUTY

10/1

BA _____
032200 04/05/00
1003 W66 H 811 1:00

10/1

Annette Norton

From: Heather Mullins <rhvbbbr@yahoo.com>
Sent: Monday, February 07, 2022 11:27 PM
To: Annette Norton
Subject: Re: Culvert Agreement

DRIVEWAY PERMIT APPLICATION

TO: THE UPSHUR COUNTY COMMISSIONERS COURT
COUNTY OF UPSHUR
GILMER, TEXAS

PRECINCT 3

DATE February 7, 2022

Formal notice is hereby given that Ryan Mullins, whose principal address is 9600 Aspen Trail, does hereby purpose to place a driveway culvert within the ROW of County Road Aspen Trail. Proposed construction will begin, if approved, or or after the 15th day of January, 2022. I, Ryan Mullins, hereby attest that I have read the conditions set forth in this application and understand its contents. The culvert will be placed by County equipment and personnel. This is a new installation.

SIGNATURE: _____

TELEPHONE: 903-736-9068

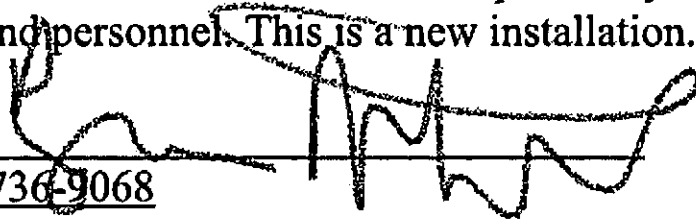

APPROVAL OF PERMIT APPLICATION

The Upshur County Commissioners Court offers no objection to the location on the right of way of your proposed driveway culvert for the address shown above. The proposed driveway structure will be a "x" culvert.

Recommended by _____

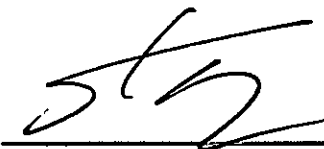

DRIVEWAY PERMIT APPLICATION

TO: THE UPSHUR COUNTY COMMISSIONERS COURT
COUNTY OF UPSHUR
GILMER, TEXAS

PRECINCT 1

DATE February 8, 2022

Formal notice is hereby given that Austin Fitch, whose principal address is 6209 Nightingale, does hereby purpose to place a driveway culvert within the ROW of County Road Nightingale. Proposed construction will begin, if approved, on or after the 15th day of February, 2022. I, Austin Fitch, hereby attest that I have read the conditions set forth in this application and understand its contents. The culvert will be placed by County equipment and personnel. This is a new installation.

SIGNATURE: 
TELEPHONE: 903-619-3554

APPROVAL OF PERMIT APPLICATION

The Upshur County Commissioners Court offers no objection to the location on the right of way of your proposed driveway culvert for the address shown above. The proposed driveway structure will be a "x ' culvert.

Recommended by 

APPROVED ON THIS _____ DAY OF _____, 2022.

DRIVEWAY PERMIT APPLICATION

TO: THE UPSHUR COUNTY COMMISSIONERS COURT
COUNTY OF UPSHUR
GILMER, TEXAS

PRECINCT 1 DATE February 11, 2022

Formal notice is hereby given that Ernest Griggs, whose principal address is 7990 Swallow Road, does hereby purpose to place a driveway culvert within the ROW of County Road Swallow Road. Proposed construction will begin, if approved, on or after the 28th day of February, 2022 I, Ernest Griggs, hereby attest that I have read the conditions set forth in this application and understand its contents. The culvert will be placed by County equipment and personnel. This is a new installation.

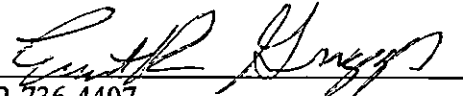
SIGNATURE: 
TELEPHONE: 972-736-4407

APPROVAL OF PERMIT APPLICATION

The Upshur County Commissioners Court offers no objection to the location on the right of way of your proposed driveway culvert for the address shown above. The proposed driveway structure will be a "x ' culvert.

Recommended by 

APPROVED ON THIS _____ DAY OF _____, 20__.

DRIVEWAY PERMIT APPLICATION

TO: THE UPSHUR COUNTY COMMISSIONERS COURT
COUNTY OF UPSHUR
GILMER, TEXAS

PRECINCT 1

DATE February 11, 2022

Formal notice is hereby given that Shirley Westlund, whose principal address is 7954 Swallow Road, does hereby purpose to place a driveway culvert within the ROW of County Road Swallow Road. Proposed construction will begin, if approved, on or after the 28th day of February, 2022. I, Shirley Westlund, hereby attest that I have read the conditions set forth in this application and understand its contents. The culvert will be placed by County equipment and personnel. This is a new installation.

SIGNATURE: _____

TELEPHONE: 903-734-1010

APPROVAL OF PERMIT APPLICATION

The Upshur County Commissioners Court offers no objection to the location on the right of way of your proposed driveway culvert for the address shown above. The proposed driveway structure will be a "x ' culvert.

Recommended by _____

APPROVED ON THIS _____ DAY OF _____, 20__.

DRIVEWAY PERMIT APPLICATION

TO: THE UPSHUR COUNTY COMMISSIONERS COURT
COUNTY OF UPSHUR
GILMER, TEXAS

PRECINCT 4

DATE February 22, 2022

Formal notice is hereby given that Charles Ferrell, whose principal address is 836 Zubin Road, does hereby purpose to place a driveway culvert within the ROW of County Road. Proposed construction will begin, if approved, on or after the 15th day of March, 2022. I, Charles Ferrell, hereby attest that I have read the conditions set forth in this application and understand its contents. The culvert will be placed by County equipment and personnel. This is a new installation.

SIGNATURE: *Charles Ferrell*
TELEPHONE: 903-445-6722

APPROVAL OF PERMIT APPLICATION

The Upshur County Commissioners Court offers no objection to the location on the right of way of your proposed driveway culvert for the address shown above. The proposed driveway structure will be a "x ' culvert.

Recommended by *[Signature]*

APPROVED ON THIS _____ DAY OF _____, 2022.

DRIVEWAY PERMIT APPLICATION

TO: THE UPSHUR COUNTY COMMISSIONERS COURT
COUNTY OF UPSHUR
GILMER, TEXAS

PRECINCT: 2

DATE:

Formal notice is hereby given that Robert Wingate, whose principal address is (no number yet) North Sego Lilly Road, does hereby purpose to place a driveway culvert within the ROW of County Road N. Sego Lilly Road. Proposed construction will begin, if approved, on or after the day of March 15, 2022.

I, Robert Wingate, hereby attest that I have read the conditions set forth in this application and understand its contents. The culvert will be placed by County equipment and personnel. This is a new.

SIGNATURE:

TELEPHONE: 903-930-9625

APPROVAL OF PERMIT APPLICATION

The Upshur County Commissioners Court offers no objection to the location on the right of way of your proposed driveway culvert for the address shown above. The proposed driveway structure will be a "x" culvert.

Recommended by

APPROVED ON THIS _____ DAY OF _____, 20__.

DRIVEWAY PERMIT APPLICATION

TO: THE UPSHUR COUNTY COMMISSIONERS COURT
COUNTY OF UPSHUR
GILMER, TEXAS

PRECINCT: 1

DATE: February 25, 2022

Formal notice is hereby given that Kyle Poma, whose principal address is 7122 Green Hills Road, does hereby purpose to place a driveway culvert within the ROW of County Road Green Hills Road. Proposed construction will begin, if approved, on or after the 15th day of March, 2022. I, Kyle Poma, hereby attest that I have read the conditions set forth in this application and understand its contents. The culvert will be placed by County equipment and personnel. This is a new installation.

SIGNATURE: 

TELEPHONE: 909-238-9803

APPROVAL OF PERMIT APPLICATION

The Upshur County Commissioners Court offers no objection to the location on the right of way of your proposed driveway culvert for the address shown above. The proposed driveway structure will be a _____ "x" _____' culvert.

Recommended by 

APPROVED ON THIS _____ DAY OF _____, 20__.

DRIVEWAY PERMIT APPLICATION

TO: THE UPSHUR COUNTY COMMISSIONERS COURT
COUNTY OF UPSHUR
GILMER, TEXAS

PRECINCT 1

DATE: March 16, 2022

Formal notice is hereby given that Courtney Smith, whose principal address is 904 Azalea Road, does hereby purpose to place a driveway culvert within the ROW of County Road. Proposed construction will begin, if approved, on or after the 31st day of March, 2022. I, Courtney Smith, hereby attest that I have read the conditions set forth in this application and understand its contents. The culvert will be placed by County equipment and personnel. This is a new installation.

SIGNATURE: _____

TELEPHONE: 903-801-1118

APPROVAL OF PERMIT APPLICATION

The Upshur County Commissioners Court offers no objection to the location on the right of way of your proposed driveway culvert for the address shown above. The proposed driveway structure will be a _____ "x" _____' culvert.

Recommended by _____

APPROVED ON THIS _____ DAY OF _____, 2015.

DRIVEWAY PERMIT APPLICATION

TO: THE UPSHUR COUNTY COMMISSIONERS COURT
COUNTY OF UPSHUR
GILMER, TEXAS

PRECINCT: 3

DATE: April 6, 2022

Formal notice is hereby given that Roberto Resendez Ramirez, whose principal address is 5101 Sweet Gum Road, does hereby purpose to place driveway culverts within the ROW of County Road Sweet Gum. Proposed construction will begin, if approved, on or after the 15th day of March, 2022. I, Roberto Resendez Ramirez, hereby attest that I have read the conditions set forth in this application and understand its contents. The culverts will be placed by County equipment and personnel. This is both a new installation and an extension.

SIGNATURE: _____

TELEPHONE: 361/288-9587

APPROVAL OF PERMIT APPLICATION

The Upshur County Commissioners Court offers no objection to the location on the right of way of your proposed driveway culvert for the address shown above. The proposed driveway structure will be a "x ' culvert.

Recommended by _____

APPROVED ON THIS _____ DAY OF _____, 20__.

DRIVEWAY PERMIT APPLICATION

TO: THE UPSHUR COUNTY COMMISSIONERS COURT
COUNTY OF UPSHUR
GILMER, TEXAS

PRECINCT: 1 DATE: April 6, 2022

Formal notice is hereby given that Jeffrey Hill, whose principal address is 780 Azalea, does hereby purpose to place a driveway culvert within the ROW of County Road Azalea. Proposed construction will begin, if approved, on or after the 15th-day of April, 2022. I, Jeffrey Hill, hereby attest that I have read the conditions set forth in this application and understand its contents. The culvert will or be placed by County equipment and personnel. This is a new installation.

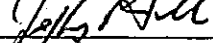
SIGNATURE: 
TELEPHONE: 972-762-5404

APPROVAL OF PERMIT APPLICATION

The Upshur County Commissioners Court offers no objection to the location on the right of way of your proposed driveway culvert for the address shown above. The proposed driveway structure will be a "x ' culvert.

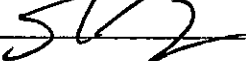
Recommended by 

APPROVED ON THIS _____ DAY OF _____, 20__.

DRIVEWAY PERMIT APPLICATION

TO: THE UPSHUR COUNTY COMMISSIONERS COURT
COUNTY OF UPSHUR
GILMER, TEXAS

PRECINCT: 1 DATE: April 6, 2022

Formal notice is hereby given that Marcia Lee Spence, whose principal address is 695 Azalea, does hereby purpose to place a driveway culvert within the ROW of County Road Azalea. Proposed construction will begin, if approved, on or after the 15th-day of April, 2022. I, Marcia Lee Spence, hereby attest that I have read the conditions set forth in this application and understand its contents. The culvert will or be placed by County equipment and personnel. This is a new installation.

SIGNATURE: _____
TELEPHONE: 972-762-5404

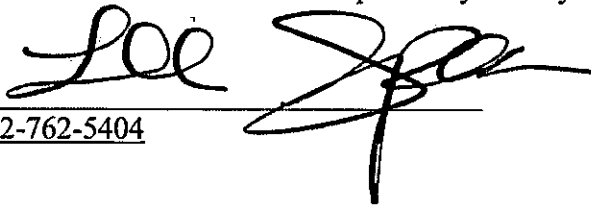

APPROVAL OF PERMIT APPLICATION

The Upshur County Commissioners Court offers no objection to the location on the right of way of your proposed driveway culvert for the address shown above. The proposed driveway structure will be a "x ' culvert.

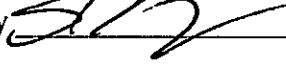
Recommended by  _____

APPROVED ON THIS _____ DAY OF _____, 20__.

NOTICE OF PROPOSED INSTALLATION
PIPE AND/OR UTILITY LINES

TO: UPSHUR COUNTY COMMISSIONERS COURT
c/o UPSHUR COUNTY ENGINEER
UPSHUR COUNTY ROAD & BRIDGE DEPARTMENT
P. O. BOX 730
Gilmer, TX 75644

DATE:

EXPIRES: _____

Formal notice is hereby given that _____ proposes to bore a _____ line within the right-of-way of County Road _____ as follows:

3025 East Lake Drive; Fir Drive

Frontier Communications requests permission to bore 8615' of (1)-1.25" duct and 443' of (2)-1.25" ducts and to install (1) New 2'x3' HH, (17) New 17"x30" HH, (20) New 11"x11"x16" Drop box for fiber placing and splicing. **5291556**

The location and description of the proposed line and appurtenances is more fully shown by three copies of drawings attached to this notice. The line will be constructed and maintained on the County right-of-way as directed by the County Engineer in accordance with current Upshur County specifications.

Construction of this line will begin on or after the 23rd day of May, 2022 and will be completed within 90 days of the date of approval.

Firm Frontier Communications
By Shelie Brown
Title Permit Coordinator
Address 201 Flynn Road, Camarillo CA 93012

- NOTE: 1. This form to be submitted in triplicate for each proposed installation.
2. The permit shall be in effect until the utility line is removed from the right of way.
3. Inform the County Engineer if work is not completed within this time.



**FRONTIER COMMUNICATION
CONSTRUCTION SPECIFICATIONS**

- Contact Frontier Engineer CORY RIGGS at (310) 210-9882 sixty (60) days prior to need of service in order to confirm compliance, order materials, and schedule work forces. NOTE: FRONTIER COMMUNICATIONS, INCORPORATED, RESERVES THE RIGHT TO REFUSE ANY CONDUIT, PULL BOXES, MANHOLES, OR UTILITY BOXES THAT DEVIATE FROM PLANS AND SPECIFICATIONS.
- All conduit riser bends to have a minimum thirty-six (36) inch radius.
- All horizontal ninety (90) degree bends shall have a minimum radius of 12.5 feet and all vertical ninety (90) degree bends shall have a minimum radius of three feet. No more than two ninety (90) degree horizontal bends shall be placed in any single run unless otherwise specified. Contact the Frontier engineer concerning any required deviations.
- All conduit must be proven using a mandrol no less than a 1/2" smaller than the conduit placed. Wall to wall measurements must be taken with a measured tape and a 3/8" polypropylene pull rope in each duct. An accurate wall to wall measurement of conduit placed must be As-built on an approved Frontier construction plan. A copy of the As-built conduit work order must be provided to the Frontier inspector assigned to your project.
- Place weatherproof caps on all terminated conduits.
- Approved plastic conduit (PVC Sch. 40, TYPE-C or HDPE (2") is to be used in underground construction unless otherwise specified.
- Conduit terminated on a pole must be PVC Sch. 80. Location of riser on pole will be called out by engineering on the construction plan.
- Conduit placed in same trench with primary power conduit must be separated by a minimum of twelve (12) inches of well-packed sand or three inches of concrete, and have a minimum of thirty-six (36) inches of cover when placed behind curb face. All street crossings and conduits placed in the driven portion of the roadway must have a minimum of forty-eight (48) inches of cover to top of pipe. CONTACT THE FRONTIER INSPECTOR 48 HOURS BEFORE TRENCHING AND UPON COMPLETION OF YOUR SUBSTRUCTURES TO SCHEDULE THE FINAL INSPECTION.

CONSTRUCTION PACKAGE

**FDH - 3025 E LAKE DR
E LAKE DR & FIR RD
GLADEWATER, TX 75647**

ABBREVIATIONS

BLDG	BUILDING	PED	PEDESTAL (UTILITY)
CL	CENTER LINE	PVC	POLYVINYL CHLORIDE
CONC	CONCRETE	P/L	PROPERTY LINE
CSW	CONCRETE SIDEWALK	RR	RAILROAD
DWY	EX. DRIVEWAY	ITD ROW	RIGHT OF WAY
EOC	EDGE OF CURB	SL	STREET LIGHT
EOP	EDGE OF PAVEMENT	W-BLDG	WALL TO BUILDING
ETW	ETW LINE	W-P	WALL TO POLE
HH	HANDHOLE	W-W	WALL TO WALL
MH	MANHOLE	P.U.E.	PUBLIC UTILITY EASEMENT
NTS	NOT TO SCALE	C/G	CURB & GUTTER

**PERMITTING AGENCY:
UPSHUR COUNTY**

**PICK UP POINT:
COUNTY LIMIT**

**PATH FOOTAGE:
BORE = 9058'**

MATERIALS:
(11) NEW 2X3 HH
(17) NEW 17"X30" HH
(20) NEW 11"X11"X16" DROP BOX
8615' OF (1)-1.25" DUCT
443' OF (2)-1.25" DUCTS



**Know what's below.
Call before you dig.**

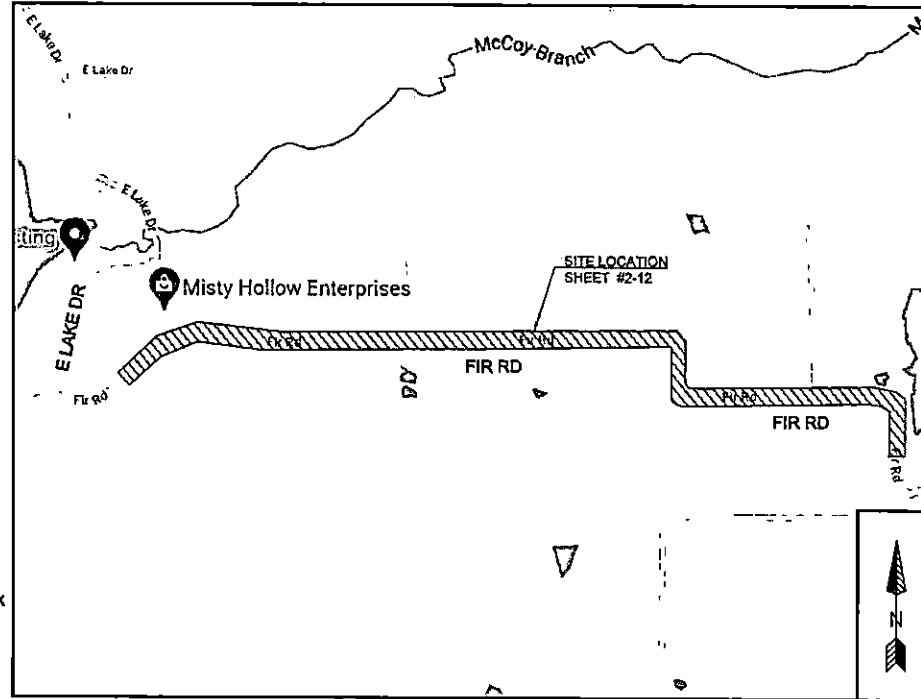

**VICINITY MAP
NTS**

-HDPE AND PVC FOOTAGES DO NOT INCLUDE SWEEPS
-ACTUAL FOOTAGES OF HDPE AND PVC WILL BE NEEDED TO ORDER MATERIALS. PLEASE INCLUDE MEASURED TAPE IN ALL PVCs.
-FRONTIER INSPECTOR SHALL BE PRESENT ON SITE WHEN CONTRACTOR NEEDS TO ACCESS ANY EXISTING FRONTIER FACILITY.

LEGEND

	New Trench
	New Bore
	Existing Gas
	Existing Water
	Existing Telephone
	Existing Sewer
	Existing Storm Drain
	Existing Electric
	Existing Manhole
	Existing Handhole (2'x3' or 17'x30')
	DSLAM
	X-CONNECT
	POWER PEDESTAL
	TELCO PEDESTAL
	3' X 5' PULL BOX
	POLE

**Frontier
COMMUNICATIONS**

JOB ID: 5291556	DATE: 12/29/2021
TITLE: FDH - 3025 E LAKE DR	
STREET ADDRESS: 3025 E LAKE DR	
CITY/STATE: GLADEWATER, TX 75647 (UPSHUR COUNTY)	
FTR ENGINEER: CORY RIGGS (310) 210-9882	
FTR INSPECTOR: JAMES WEST (872) 578-3224	
 CHC CONSULTING ENGINEERED BY: CHC CONSULTING, LLC 8086 RIO SAN DIEGO DR, STE 400 SAN DIEGO, CA 92108	DRAWN BY: CHC CONSULTING EST. #:
SHEET#: 1 OF 13	

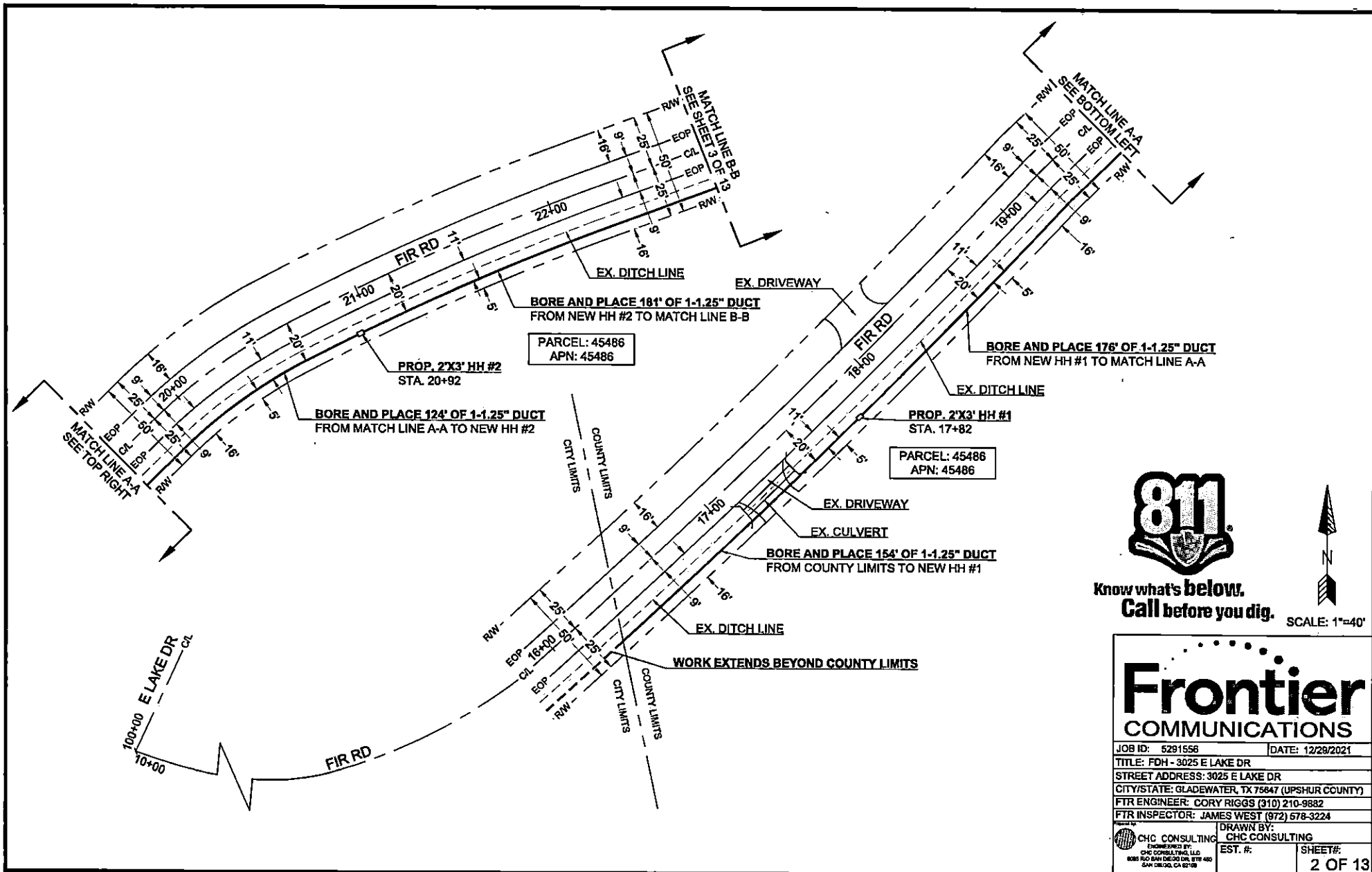

Know what's below.
Call before you dig.

SCALE: 1"=40'



Frontier COMMUNICATIONS

JOB ID: 6291556 | DATE: 12/29/2021
 TITLE: FDH - 3025 E LAKE DR
 STREET ADDRESS: 3025 E LAKE DR
 CITY/STATE: GLADEWATER, TX 75847 (UPSHUR COUNTY)
 FTR ENGINEER: CORY RIGGS (31D) 210-9882
 FTR INSPECTOR: JAMES WEST (972) 578-3224

CHC CONSULTING <small>ENGINEERED BY: CHC CONSULTING, LLC 8005 RFD 54M DECK DR, STE 400 SAN DIEGO, CA 92108</small>	DRAWN BY: CHC CONSULTING
	EST. #: SHEET#:

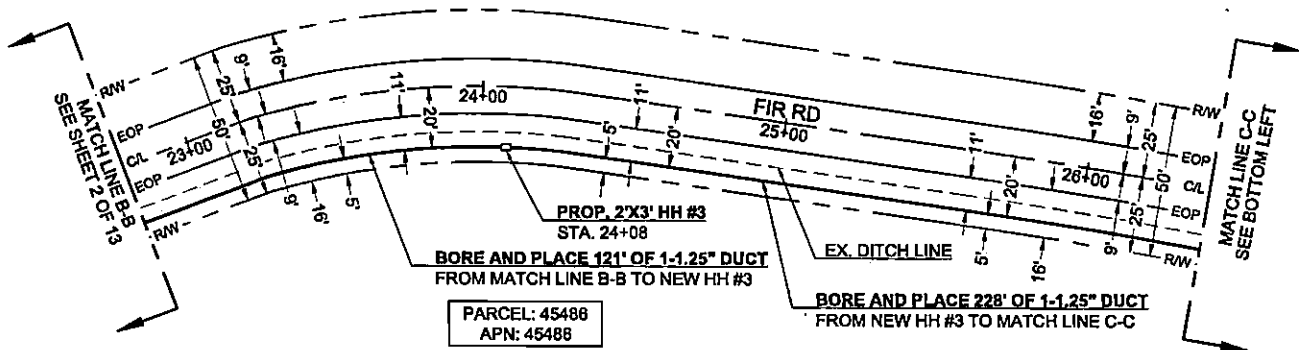

PARCEL: 45486
APN: 45486

BORING AND PLACE 228' OF 1-1.25" DUCT FROM NEW HH #3 TO MATCH LINE C-C

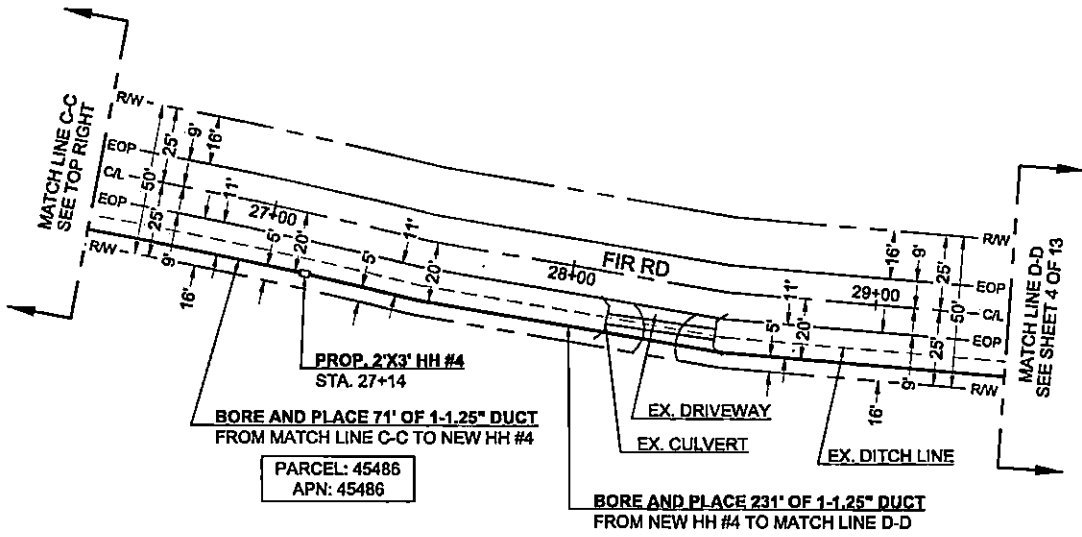

PARCEL: 45486
APN: 45486

BORING AND PLACE 231' OF 1-1.25" DUCT FROM NEW HH #4 TO MATCH LINE D-D



Know what's below.
Call before you dig.

SCALE: 1"=40'



Frontier COMMUNICATIONS

JOB ID: 5291556 | DATE: 12/28/2021
 TITLE: FDH - 3025 E LAKE DR
 STREET ADDRESS: 3025 E LAKE DR
 CITY/STATE: GLADEWATER, TX 75847 (UPSHUR COUNTY)
 FTR ENGINEER: CORY RIGGS (310) 210-8882
 FTR INSPECTOR: JAMES WEST (872) 578-3224

CHC CONSULTING ENGINEERED BY: CHC CONSULTING, LLC 8086 RIO SAN DIEGO DR, STE 400 SAN DIEGO, CA 92118	DRAWN BY: CHC CONSULTING	EST. #: SHEET#:
	EST. #: SHEET#:	

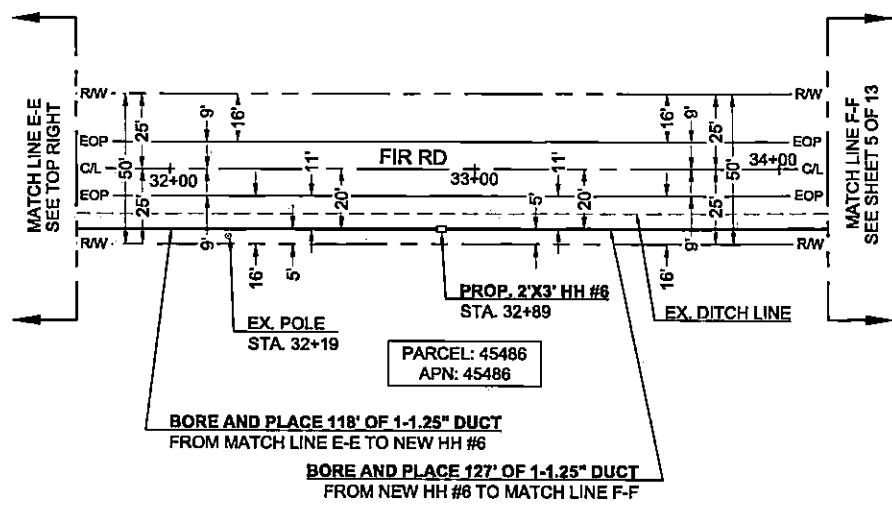
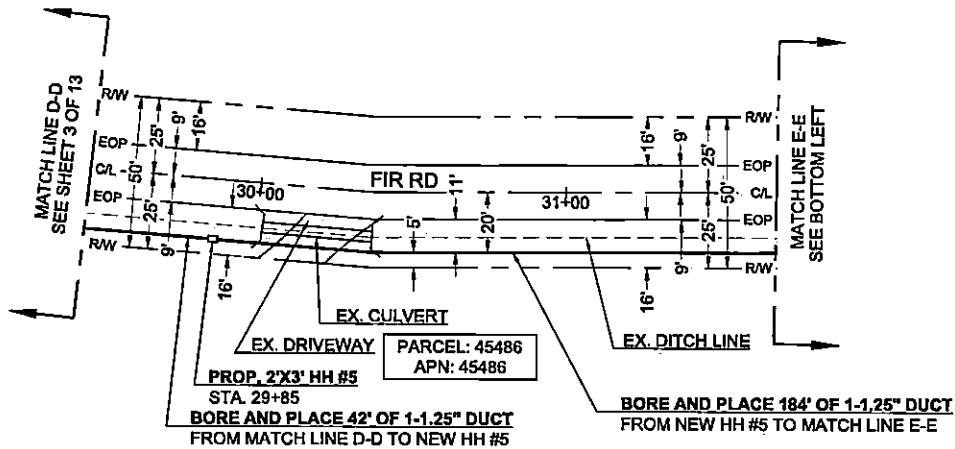

Know what's below.
Call before you dig.

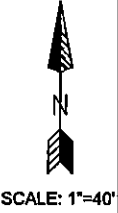

Frontier COMMUNICATIONS

JOB ID: 6291556	DATE: 12/29/2021
TITLE: FDH - 3025 E LAKE DR	
STREET ADDRESS: 3025 E LAKE DR	
CITY/STATE: GLADEWATER, TX 78647 (UPSHUR COUNTY)	
FTR ENGINEER: CORY RIGGS (310) 210-9882	
FTR INSPECTOR: JAMES WEST (872) 578-3224	
CHC CONSULTING ENGINEERED BY: CHC CONSULTING, LLC 8088 180 SAN DIEGO DR, #18 400 SAN DIEGO, CA 92178	DRAWN BY: CHC CONSULTING EST. #:
SHEET#: 4 OF 13	

CURVE	RADIUS	LENGTH	DELTA
C1	3'	5'	90°

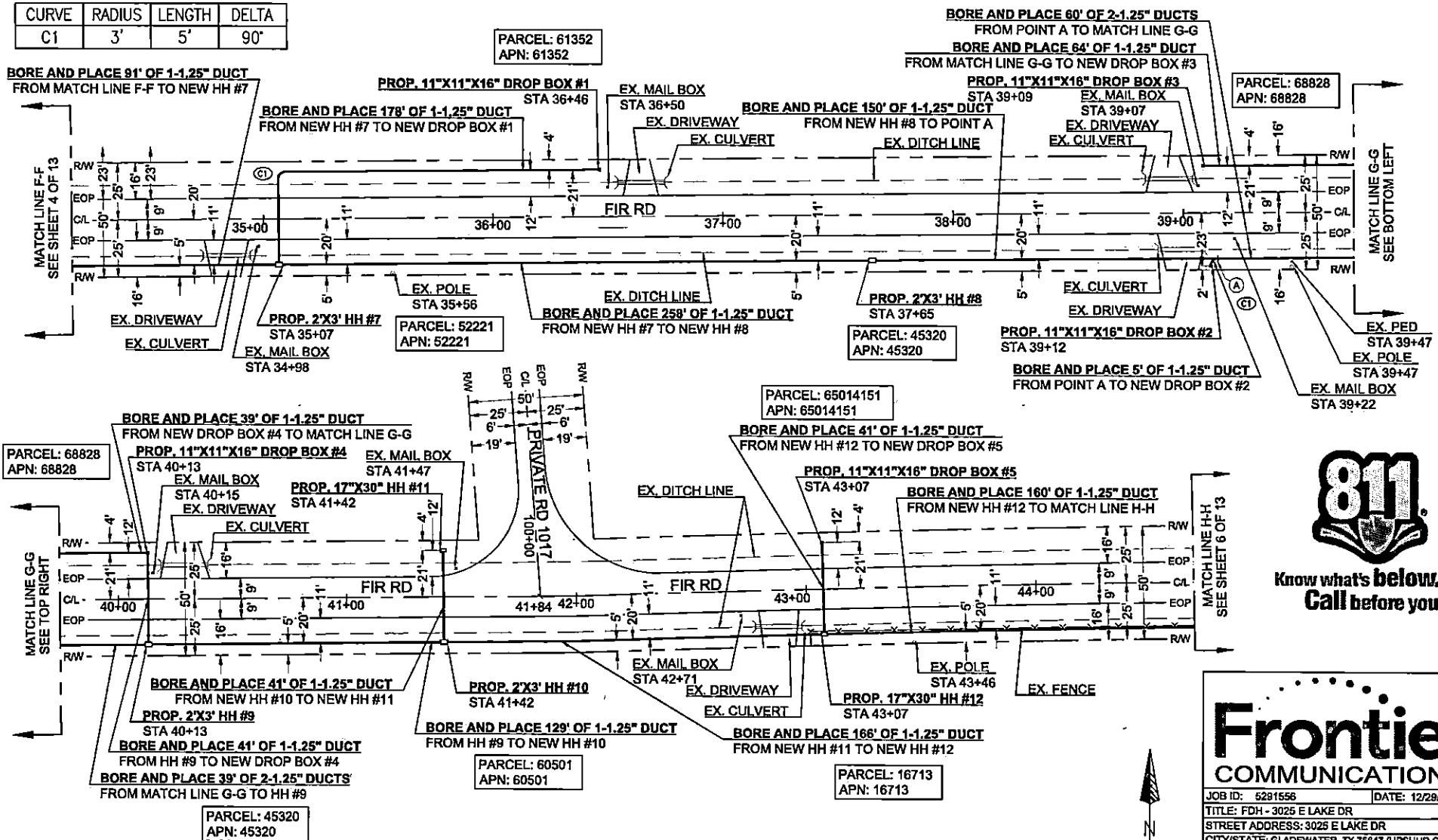

Know what's below.
Call before you dig.

Frontier COMMUNICATIONS

JOB ID: 5281558 DATE: 12/29/2021
 TITLE: FDH - 3025 E LAKE DR
 STREET ADDRESS: 3025 E LAKE DR
 CITY/STATE: GLADEWATER, TX 75847 (UPSHUR COUNTY)
 FTR ENGINEER: CORY RIGGS (310) 210-9882
 FTR INSPECTOR: JAMES WEST (872) 578-3224

DRAWN BY: CHC CONSULTING
 EST. #: SHEET#: 5 OF 13

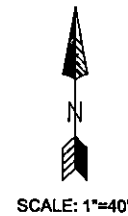

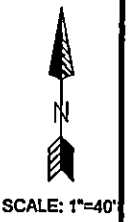
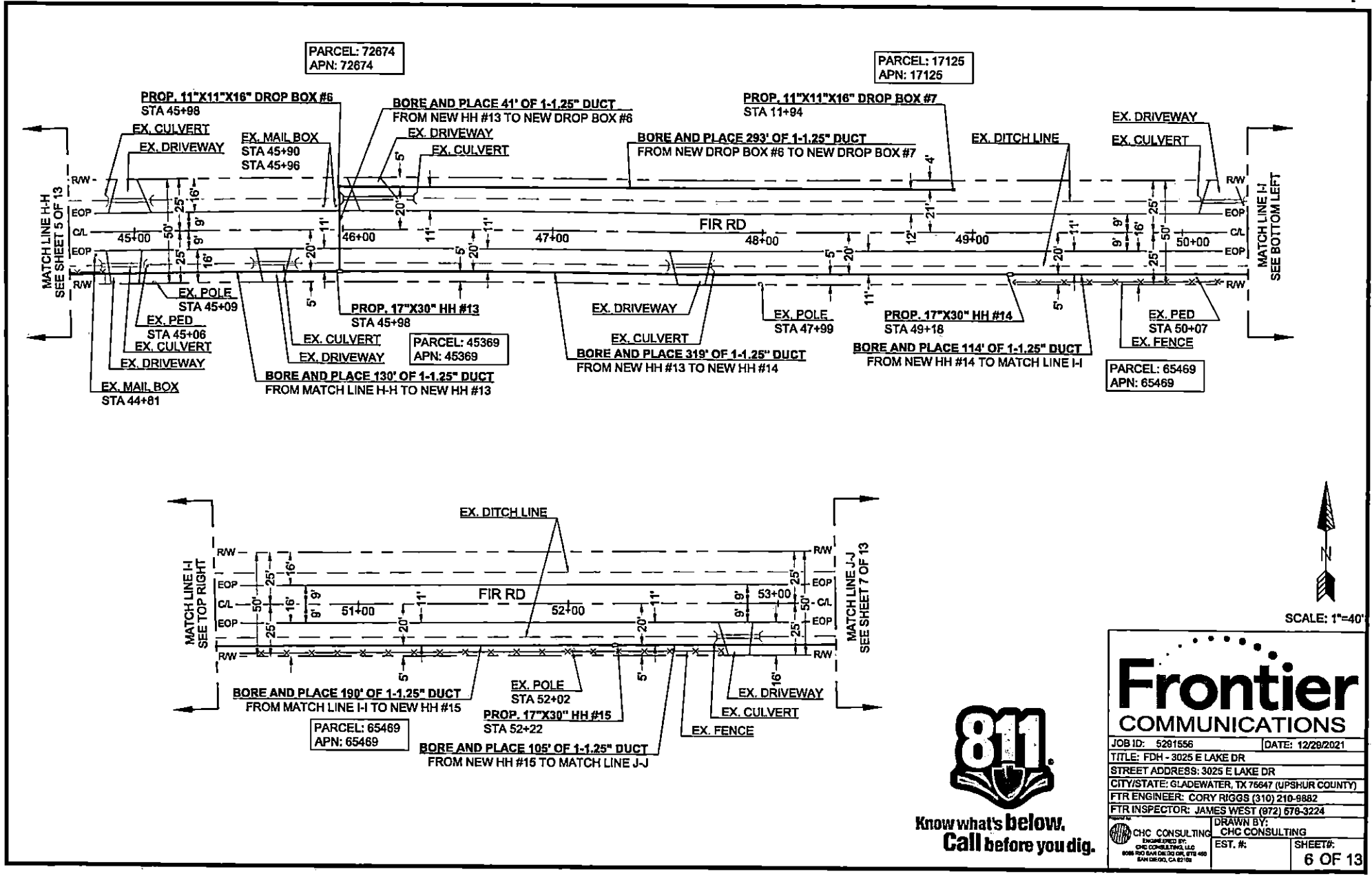

Know what's below.
Call before you dig.

Frontier COMMUNICATIONS	
JOB ID: 5281556	DATE: 12/28/2021
TITLE: FDH - 3025 E LAKE DR	
STREET ADDRESS: 3025 E LAKE DR	
CITY/STATE: GLADEWATER, TX 76647 (UPSHUR COUNTY)	
FTR ENGINEER: CORY RIGGS (310) 210-8882	
FTR INSPECTOR: JAMES WEST (972) 678-3224	
CHC CONSULTING <small>ENGINEERED BY: CHC CONSULTING, LLC 8008 RIO SAN DIEGO DR, STE 400 SAN DIEGO, CA 92128</small>	DRAWN BY: CHC CONSULTING EST. #:
SHEET#: 6 OF 13	

CURVE	RADIUS	LENGTH	DELTA
C1	3'	4'	67'

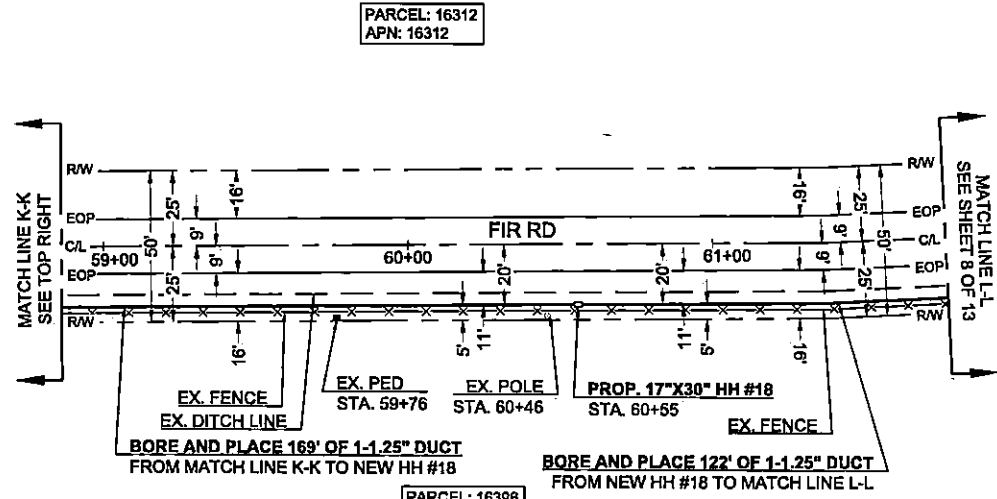
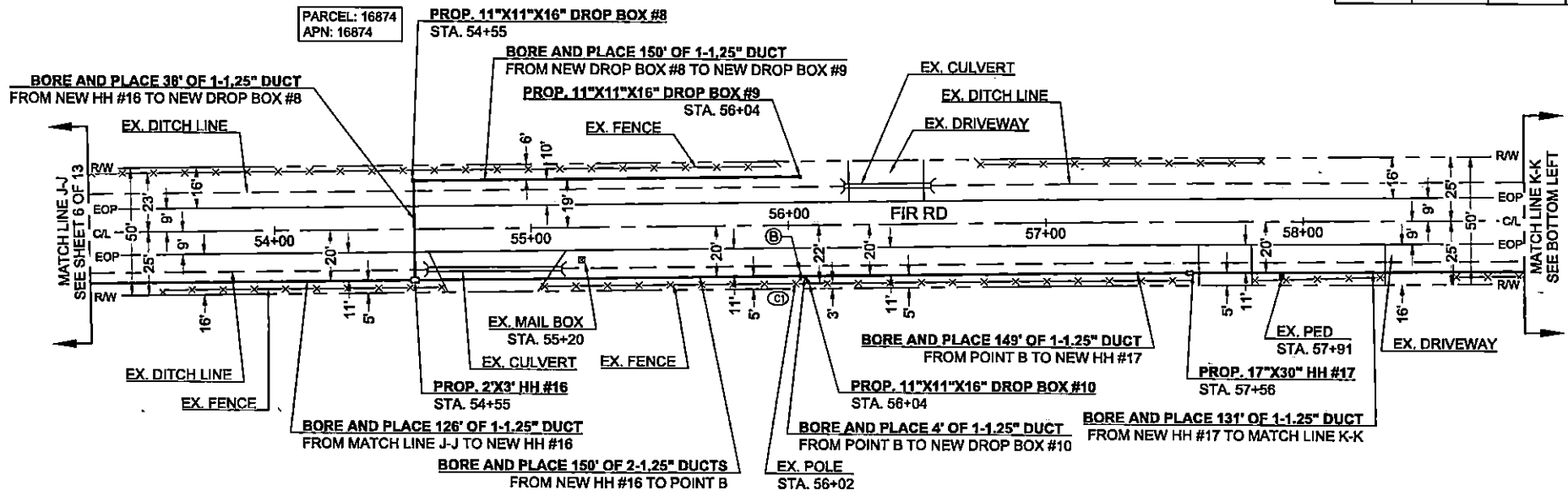

Know what's below.
Call before you dig.

SCALE: 1"=40'



Frontier COMMUNICATIONS

JOB ID: 5291558 DATE: 12/29/2021
 TITLE: FDH - 3025 E LAKE DR
 STREET ADDRESS: 3025 E LAKE DR
 CITY/STATE: GLADEWATER, TX 76847 (UPSHUR COUNTY)
 FTR ENGINEER: CORY RIGGS (310) 210-9882
 FTR INSPECTOR: JAMES WEST (872) 578-3224

DRAWN BY: CHC CONSULTING
 EST. #: SHEET#: 7 OF 13

PARCEL: 16312
APN: 16312

PARCEL: 16398
APN: 16396

PARCEL: 16874
APN: 16874

CURVE	RADIUS	LENGTH	DELTA
C1	12'	7'	34'
C2	50'	49'	57'

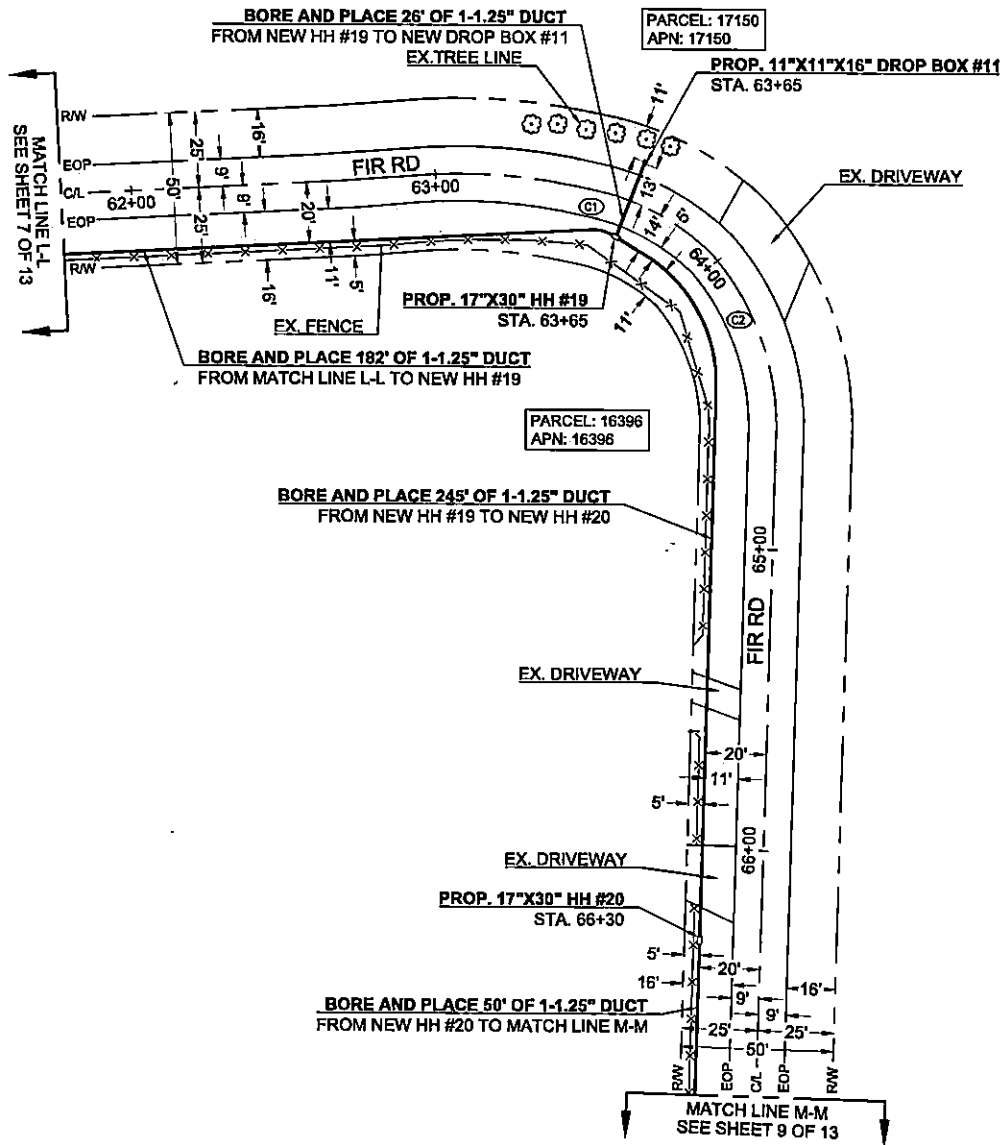

Know what's below.
Call before you dig.

SCALE: 1"=40'



Frontier COMMUNICATIONS

JOB ID: 6291656 DATE: 12/29/2021
 TITLE: FDH - 3025 E LAKE DR
 STREET ADDRESS: 3025 E LAKE DR
 CITY/STATE: GLADEWATER, TX 75647 (UPSHUR COUNTY)
 FTR ENGINEER: CORY RIGGS (310) 210-9882
 FTR INSPECTOR: JAMES WEST (972) 578-3224

CHC CONSULTING <small>ENGINEERED BY: CHC CONSULTING, LLC 8000 190 BARR DR OFFICE, SUITE 100 IRVING, TEXAS 75039</small>	DRAWN BY: CHC CONSULTING	EST. #:	SHEET#:
			8 OF 13

CURVE	RADIUS	LENGTH	DELTA
C1	3'	4'	71°

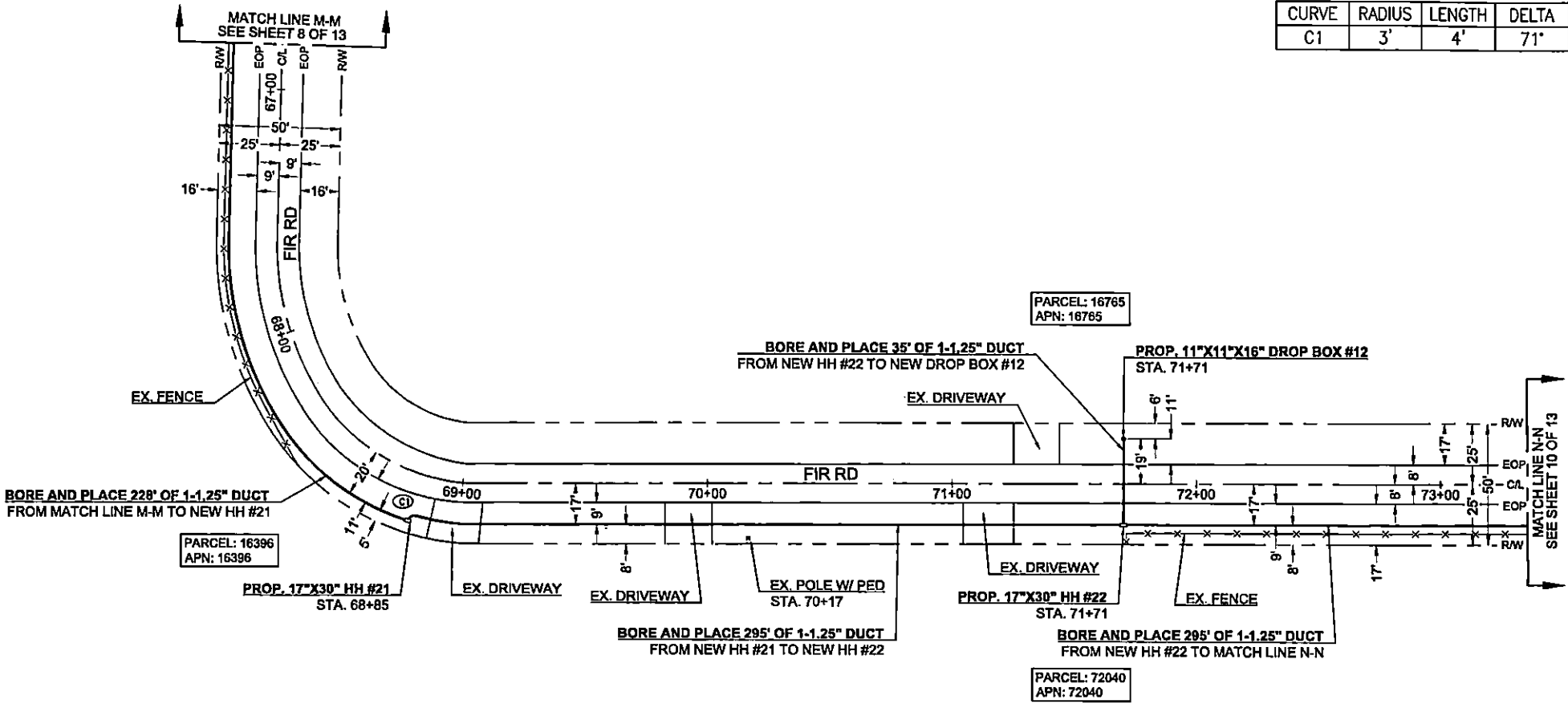

Know what's below.
Call before you dig.

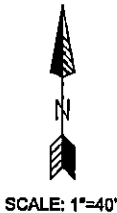

Frontier COMMUNICATIONS

JOB ID: 6291556 DATE: 12/29/2021

TITLE: FDH - 3025 E LAKE DR

STREET ADDRESS: 3025 E LAKE DR

CITY/STATE: GLADEWATER, TX 75647 (UPSHUR COUNTY)

FTR ENGINEER: CORY RIGGS (310) 210-9882

FTR INSPECTOR: JAMES WEST (972) 578-3224

DRAWN BY: CHC CONSULTING

EST. #: SHEET#: 9 OF 13

CHC CONSULTING
ENGINEERED BY:
CHC CONSULTING, LLC
8085 RIO SAN DIEGO DR, 8TH FLOOR
SAN DIEGO, CA 92128

CURVE	RADIUS	LENGTH	DELTA
C1	3'	5'	80'

PARCEL: 66590
APN: 66590

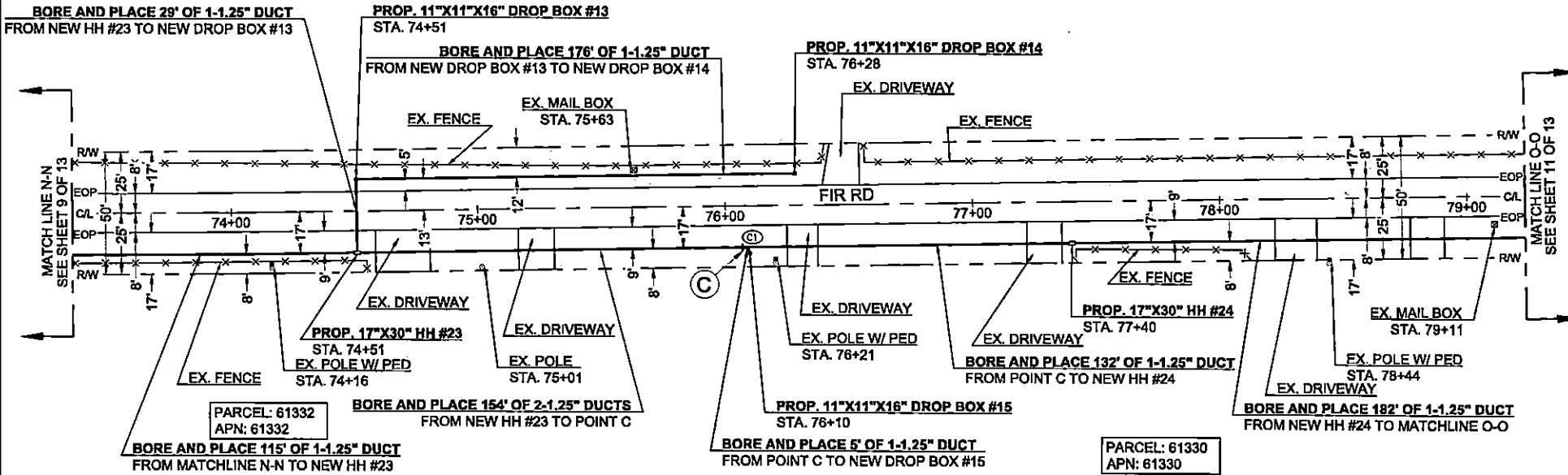

PARCEL: 61332
APN: 61332

PARCEL: 61316
APN: 61316

PARCEL: 61330
APN: 61330



Know what's below.
Call before you dig.



SCALE: 1"=40'

Frontier COMMUNICATIONS

JOB ID: 6291556 DATE: 12/29/2021

TITLE: FDH - 3025 E LAKE DR
STREET ADDRESS: 3025 E LAKE DR
CITY/STATE: GLADEWATER, TX 75847 (UPSHUR COUNTY)

FTR ENGINEER: CORY RIGGS (310) 210-9882
FTR INSPECTOR: JAMES WEST (872) 578-3224

DRAWN BY: CHC CONSULTING
EST. #:

CHC CONSULTING
ENGINEERED BY:
CHC CONSULTING, LLC
8000 PEO SAN DIEGO DR, STE 400
SAN DIEGO, CA 92128

SHEET#: 10 OF 13

CURVE	RADIUS	LENGTH	DELTA
C1	3'	5'	88'

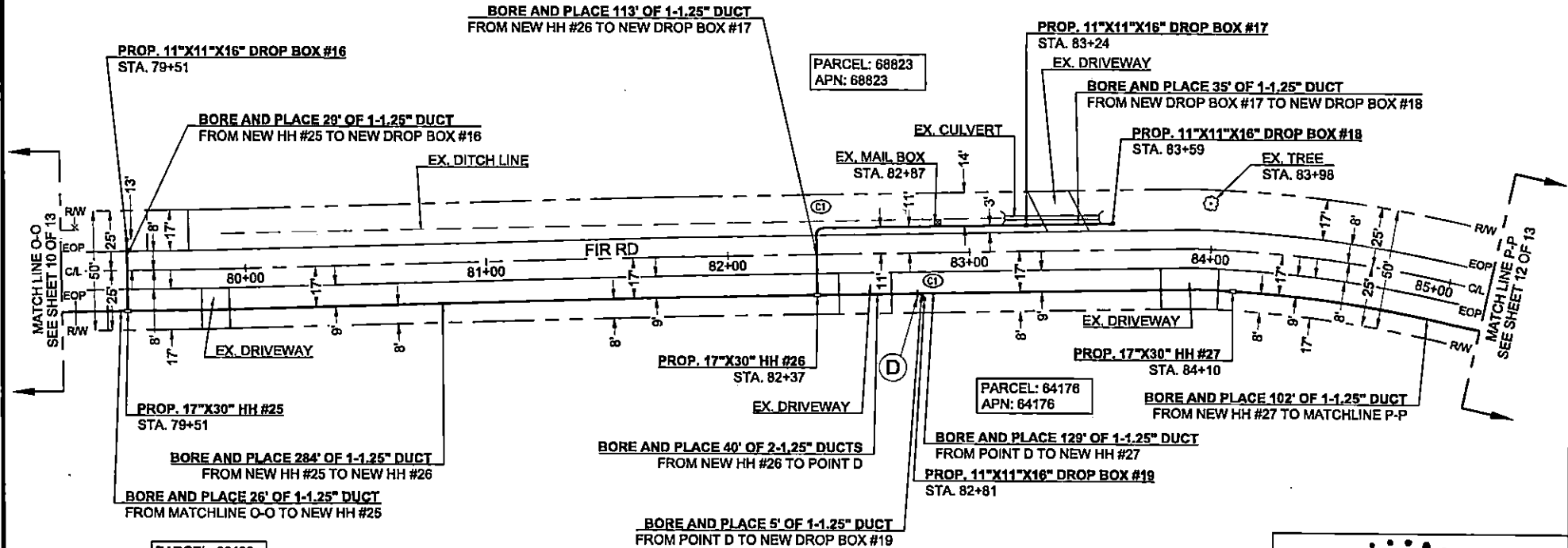

PARCEL: 60498
APN: 60498

PARCEL: 68823
APN: 68823

PARCEL: 64178
APN: 64178



Know what's below.
Call before you dig.



SCALE: 1"=40'

Frontier COMMUNICATIONS

JOB ID: 5291556 DATE: 12/29/2021

TITLE: FDH - 3025 E LAKE DR
STREET ADDRESS: 3025 E LAKE DR
CITY/STATE: GLADEWATER, TX 75847 (UPSHUR COUNTY)
FTR ENGINEER: CORY RIGGS (310) 210-9882
FTR INSPECTOR: JAMES WEST (972) 578-3224

DRAWN BY: CHC CONSULTING
EST. #: SHEET#: 11 OF 13

CHC CONSULTING
ENGINEERED BY:
CHC CONSULTING, LLC
1000 BOW BOW DRIVE DR. STE 400
IRVINE, CA 92618

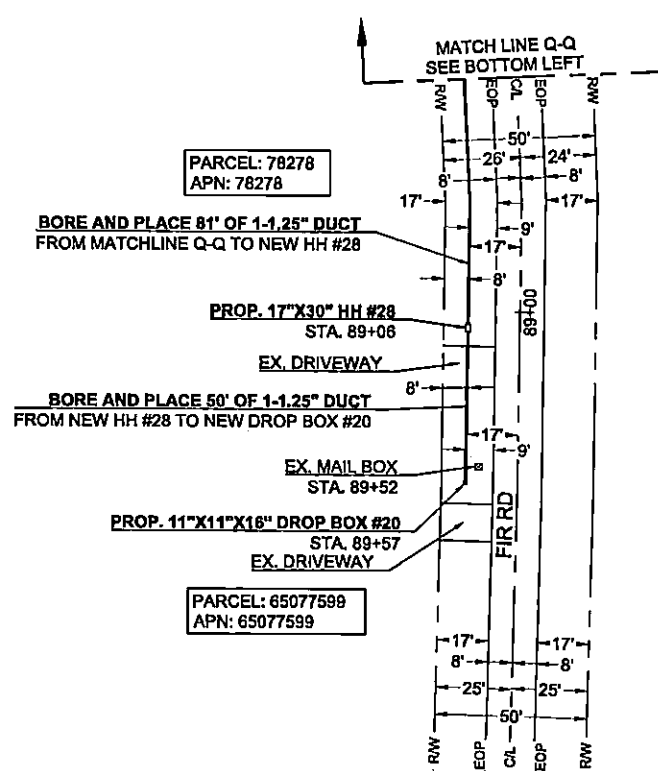
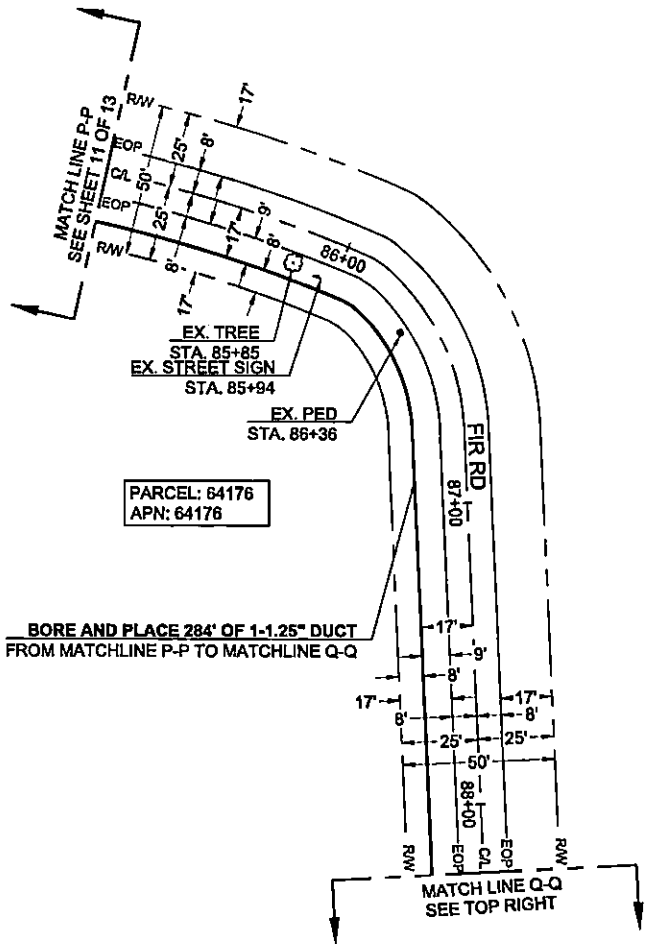

Know what's below.
 Call before you dig.



SCALE: 1"=40'

Frontier COMMUNICATIONS	
JOB ID: 5291556	DATE: 12/29/2021
TITLE: FDH - 3025 E LAKE DR	
STREET ADDRESS: 3025 E LAKE DR	
CITY/STATE: GLADEWATER, TX 75647 (UPSHUR COUNTY)	
FTR ENGINEER: CORY RIGGS (310) 210-9882	
FTR INSPECTOR: JAMES WEST (972) 578-3224	
CHC CONSULTING <small>ENGINEERED BY: CHC CONSULTING, LLC 5000 RIO SAN DIEGO DR, STE 400 SAN DIEGO, CA 92108</small>	DRAWN BY: CHC CONSULTING EST. #: SHEET#:
	12 OF 13

MINIMUM STANDARDS FOR DIRECTIONAL BORING

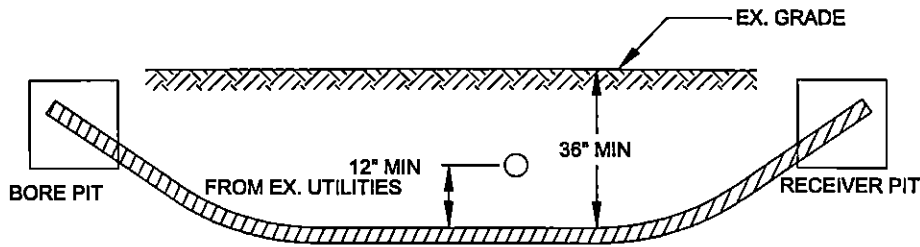

- PLACE END MARKER WITH UTILITY OWNER'S NAME DESCRIBING CONDUIT
- BORE PIT TO BE BACKFILLED AND COMPACTED IN 12" LIFTS WITH MATERIAL REMOVED
- FLOW OF DITCH MUST BE MAINTAINED AT ALL TIMES
- PROTECT ROOTS AT ALL TREE LOCATIONS, SHIFT BORE TRENCH IF NECESSARY

TYPICAL BORE DETAIL

SCALE
N.T.S. 1

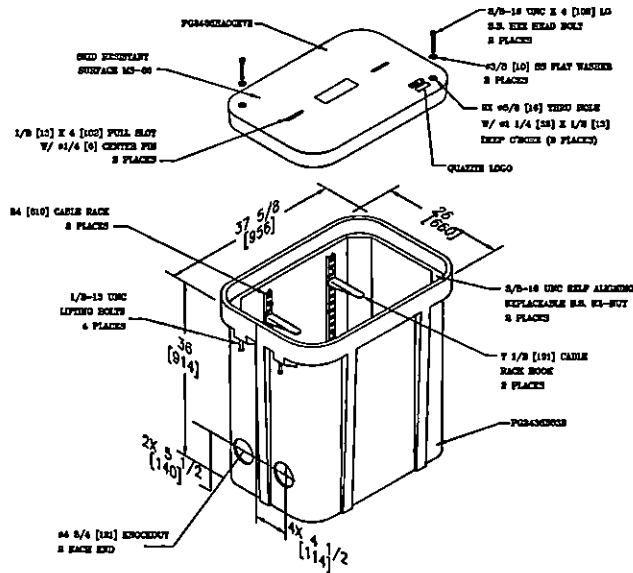

2' X 3' HAND HOLE

SCALE
N.T.S. 2

Frontier
COMMUNICATIONS

JOB ID: 6291556	DATE: 12/29/2021
TITLE: FDH - 3025 E LAKE DR	
STREET ADDRESS: 3025 E LAKE DR	
CITY/STATE: GLADEWATER, TX 76847 (UPSHUR COUNTY)	
FTR ENGINEER: CORY RIGGS (310) 210-9882	
FTR INSPECTOR: JAMES WEST (972) 578-3224	
CHC CONSULTING ENGINEERED BY: CHC CONSULTING, LLC 808 RIO SAN DIEGO, STE 402 SAN DIEGO, CA 92108	DRAWN BY: CHC CONSULTING EST. #: _____ SHEET#: 13 OF 13

County Engineer

Chairperson, Upshur County Commissioners Court

NOTICE OF PROPOSED INSTALLATION
NOTICE OF PROPOSED INSTALLATION
PIPE AND/OR UTILITY LINES

DATE: 3/4/2022

TO: UPSHUR COUNTY COMMISSIONERS COURT
c/o UPSHUR COUNTY ENGINEER
UPSHUR COUNTY ROAD & BRIDGE DEPARTMENT
P. O. BOX 730
Gilmer, TX 75644

EXPIRES: 6/4/2022

Formal notice is hereby given that Etex Telephone Coop., Inc. proposes to bore a New Fiber Optic line within the right-of-way of County Roads Collie, Chinchilla, Chipmunk, Boar, Badger, Cougar, Bluebonnet, Jackson Cir. as follows: all construction will be directional Bored in at a min depth of 48" on the upside of ditch line on stated county roads and with in county roads right.6

The location and description of the proposed line and appurtenances is more fully shown by three copies of drawings attached to this notice. The line will be constructed and maintained on the County right-of-way as directed by the County Engineer in accordance with current Upshur County specifications.

Construction of this line will begin on or after the 8 day of March, 2022 and will be completed within 90 days of the date of approval.

Firm Etex Telephone Coop., Inc.
By Martin Thompson _____
Title Right of way solicitor
Address P.O.Box 130 Gilmer Tx 75644

- NOTE: 1. This form to be submitted in triplicate for each proposed installation.
2. The permit shall be in effect until the utility line is removed from the right of way.
3. Inform the County Engineer if work is not completed within this time

APPROVAL

TO: Etex Telephone Coop., Inc.
P.O. Box 130 Gilmer Tx
75644

DATE: 3/4/2022

The Upshur County Commissioners Court offers no objections to the location on the right-of-way of your proposed New Fiber Optic line across Stated Roads as shown by accompanying drawings and notice dated 3/8/2022, except as noted below:

N/A

It is expressly understood that the Upshur County Commissioners Court does not purport, hereby, to grant and right, claim, title, or easement in or upon this county road; and it is further understood that in the future should for any reason Upshur County need to work, improve, relocate, widen, increase add to or any manner change the structure of this right-of-way line, this line, if affected, will be moved under the direction of the Upshur County Engineer and shall be relocated at the complete expense of the owner. Upshur County shall be notified a minimum of 48 hours prior to the beginning of any work.

All work on the county right-of-way shall be performed in accordance with the County Engineer's instructions. The installation shall not damage any part of the highway and adequate provisions must be made to cause minimum inconvenience to traffic and adjacent property owners. Special specifications for placing this line are as follows:

1. All ground lines are to be installed a minimum of 36 inches below the flowline of the adjacent drainage or borrow ditch.
2. All excavations within the right-of-way and not under surfacing shall be backfilled by tamping in 6 inch horizontal layers. All surplus material shall be removed from the right-of-way and the excavation finished flush with surrounding natural ground.
3. Lines crossing under surfaced roads and under surfaced cross roads within the right-of-way shall be placed by boring. Boring shall extend from crown line to crown line.
4. All lines under roads carrying pressure in excess of 50 psi shall be enclosed in satisfactory casing extending from right-of-way line to right-of-way line. Pipe used for casing may be of any type approved by the County Engineer and shall be capable of Supporting the load of roadbed and traffic and shall be so constructed that there will be no leakage of any matter through the casing for its entire length. Inside diameter of casing shall be at least 2 inches greater than the largest outside diameter of carrier pipe, joint or couplings. (Encasement is not required on lines installed 48 inches or greater below flowline.)
5. All lines, where practicable, shall be located to cross roadbed at approximately right angles thereto. No lines are to be installed under or within 50 feet of either end of a bridge unless approved by the County Engineer in writing. No lines shall be placed inside any culvert or within 10 feet of the closest point of same.
6. Parallel lines will be installed as near the right-of-way lines as is possible and no parallel line will be installed in the roadbed or between the drainage ditch and roadbed unless approved by the County Engineer in writing.
7. Overhead lines will have a minimum clearance of 18 feet above the road surface at point of crossing.
8. Operations along roadways shall be performed in such a manner that all excavated material be kept off the pavements at all times, as well as all operating equipment and materials. Do not use equipment or installation procedures which will damage any road surface or structure. The cost of any repairs to road surfaces, roadbed, structures or other right-of-way features as direct result of this installation will be borne by the owner of this line.
9. Barricades, warning signs, lights and flagmen, when necessary, shall be provided by the contractor or owner. One half of the traveled portion of the road must be open to traffic at all times. All traffic control shall be in accordance with the requirements of the current version of the Texas MUTCD.
10. Utility company shall install adequate erosion control measures for any excavation work being performed.

APPROVED:  _____

APPROVED: _____

County Engineer

Chairperson, Upshur County Commissioners Court

NOTICE OF PROPOSED INSTALLATION
NOTICE OF PROPOSED INSTALLATION
PIPE AND/OR UTILITY LINES

DATE: 3/11/2022

TO: UPSHUR COUNTY COMMISSIONERS COURT
c/o UPSHUR COUNTY ENGINEER
UPSHUR COUNTY ROAD & BRIDGE DEPARTMENT
P. O. BOX 730
Gilmer, TX 75644

EXPIRES: 6/11/2022

Formal notice is hereby given that Etex Telephone Coop., Inc. proposes to bore a New Fiber Optic line within the right-of-way of County Roads Lyles, Dahlia, Lavender, as follows: all construction will be directional Bored in at a min depth of 48" on the upside of ditch line on stated county roads and with in the county roads right of way. Installing 2-1.25" duct with a new fiber optic cable.

The location and description of the proposed line and appurtenances is more fully shown by three copies of drawings attached to this notice. The line will be constructed and maintained on the County right-of-way as directed by the County Engineer in accordance with current Upshur County specifications.

Construction of this line will begin on or after the 8 day of March, 2022 and will be completed within 90 days of the date of approval.

Firm Etex Telephone Coop., Inc.
By Martin Thompson _____
Title Right of way solicitor
Address P.O.Box 130 Gilmer Tx 75644

- NOTE: 1. This form to be submitted in triplicate for each proposed installation.
2. The permit shall be in effect until the utility line is removed from the right of way.
3. Inform the County Engineer if work is not completed within this time

APPROVAL

TO: Etex Telephone Coop., Inc.
P.O. Box 130 Gilmer Tx
75644

DATE: 3/11/2022

The Upshur County Commissioners Court offers no objections to the location on the right-of-way of your proposed New Fiber Optic line across Stated Roads as shown by accompanying drawings and notice dated 3/11/2022, except as noted below:

N/A

It is expressly understood that the Upshur County Commissioners Court does not purport, hereby, to grant and right, claim, title, or easement in or upon this county road; and it is further understood that in the future should for any reason Upshur County need to work, improve, relocate, widen, increase add to or any manner change the structure of this right-of-way line, this line, if affected, will be moved under the direction of the Upshur County Engineer and shall be relocated at the complete expense of the owner. Upshur County shall be notified a minimum of 48 hours prior to the beginning of any work.

All work on the county right-of-way shall be performed in accordance with the County Engineer's instructions. The installation shall not damage any part of the highway and adequate provisions must be made to cause minimum inconvenience to traffic and adjacent property owners. Special specifications for placing this line are as follows:

1. All ground lines are to be installed a minimum of 36 inches below the flowline of the adjacent drainage or borrow ditch.
2. All excavations within the right-of-way and not under surfacing shall be backfilled by tamping in 6 inch horizontal layers. All surplus material shall be removed from the right-of-way and the excavation finished flush with surrounding natural ground.
3. Lines crossing under surfaced roads and under surfaced cross roads within the right-of-way shall be placed by boring. Boring shall extend from crown line to crown line.
4. All lines under roads carrying pressure in excess of 50 psi shall be enclosed in satisfactory casing extending from right-of-way line to right-of-way line. Pipe used for casing may be of any type approved by the County Engineer and shall be capable of Supporting the load of roadbed and traffic and shall be so constructed that there will be no leakage of any matter through the casing for its entire length. Inside diameter of casing shall be at least 2 inches greater than the largest outside diameter of carrier pipe, joint or couplings. (Encasement is not required on lines installed 48 inches or greater below flowline.)
5. All lines, where practicable, shall be located to cross roadbed at approximately right angles thereto. No lines are to be installed under or within 50 feet of either end of a bridge unless approved by the County Engineer in writing. No lines shall be placed inside any culvert or within 10 feet of the closest point of same.
6. Parallel lines will be installed as near the right-of-way lines as is possible and no parallel line will be installed in the roadbed or between the drainage ditch and roadbed unless approved by the County Engineer in writing.
7. Overhead lines will have a minimum clearance of 18 feet above the road surface at point of crossing.
8. Operations along roadways shall be performed in such a manner that all excavated material be kept off the pavements at all times, as well as all operating equipment and materials. Do not use equipment or installation procedures which will damage any road surface or structure. The cost of any repairs to road surfaces, roadbed, structures or other right-of-way features as direct result of this installation will be borne by the owner of this line.
9. Barricades, warning signs, lights and flagmen, when necessary, shall be provided by the contractor or owner. One half of the traveled portion of the road must be open to traffic at all times. All traffic control shall be in accordance with the requirements of the current version of the Texas MUTCD.
10. Utility company shall install adequate erosion control measures for any excavation work being performed.

APPROVED: _____



APPROVED: _____

PIPE AND/OR UTILITY LINES

DATE: 3/25/2022

TO: UPSHUR COUNTY COMMISSIONERS COURT
c/o UPSHUR COUNTY ENGINEER
UPSHUR COUNTY ROAD & BRIDGE DEPARTMENT
P. O. BOX 730
Gilmer, TX 75644

EXPIRES: 6/25/2022

Formal notice is hereby given that Etex Telephone Coop., Inc. proposes to bore a New Fiber Optic line within the right-of-way of County Roads Jack Rabbit, Pulling, Mule Deer, Mink, Poinsetta as follows: All construction will be Directional Bored in at a min Depth of 48" on both sides of said roads and on the up side of ditch line with in the county right of way. Installing two 1.25" Duct with a new Fiber Optic Cable.

The location and description of the proposed line and appurtenances is more fully shown by three copies of drawings attached to this notice. The line will be constructed and maintained on the County right-of-way as directed by the County Engineer in accordance with current Upshur County specifications.

Construction of this line will begin on or after the 25 day of March, 2022 and will be completed within 90 days of the date of approval.

Firm Etex Telephone Coop., Inc.
By Martin Thompson
Title Right of way solicitor
Address P.O. Box 130 Gilmer Texas 75644

- NOTE:
1. This form to be submitted in triplicate for each proposed installation.
 2. The permit shall be in effect until the utility line is removed from the right of way.
 3. Inform the County Engineer if work is not completed within this time

APPROVAL

TO: Etex Telephone Coop., Inc
P.O. Box 130
Gilmer Texas 75644

DATE 3/25/2022

The Upshur County Commissioners Court offers no objections to the location on the right-of-way of your proposed New Fiber Optic line across Said Roads as shown by accompanying drawings and notice dated 3/25/2022, except as note N/A

It is expressly understood that the Upshur County Commissioners Court does not purport, hereby, to grant and right, claim, title, or easement in or upon this county road; and it is further understood that in the future should for any reason Upshur County need to work, improve, relocate, widen, increase add to or any manner change the structure of this right-of-way line, this line, if affected, will be moved under the direction of the Upshur County Engineer and shall be relocated at the complete expense of the owner. Upshur County shall be notified a minimum of 48 hours prior to the beginning of any work.

All work on the county right-of-way shall be performed in accordance with the County Engineer's instructions. The installation shall not damage any part of the highway and adequate provisions must be made to cause minimum inconvenience to traffic and adjacent property owners. Special specifications for placing this line are as follows:

1. All ground lines are to be installed a minimum of 36 inches below the flowline of the adjacent drainage or borrow ditch.
2. All excavations within the right-of-way and not under surfacing shall be backfilled by tamping in 6 inch horizontal layers. All surplus material shall be removed from the right-of-way and the excavation finished flush with surrounding natural ground.
3. Lines crossing under surfaced roads and under surfaced cross roads within the right-of-way shall be placed by boring. Boring shall extend from crown line to crown line.
4. All lines under roads carrying pressure in excess of 50 psi shall be enclosed in satisfactory casing extending from right-of-way line to right-of-way line. Pipe used for casing may be of any type approved by the County Engineer and shall be capable of Supporting the load of roadbed and traffic and shall be so constructed that there will be no leakage of any matter through the casing for its entire length. Inside diameter of casing shall be at least 2 inches greater than the largest outside diameter of carrier pipe, joint or couplings. (Encasement is not required on lines installed 48 inches or greater below flowline.)
5. All lines, where practicable, shall be located to cross roadbed at approximately right angles thereto. No lines are to be installed under or within 50 feet of either end of a bridge unless approved by the County Engineer in writing. No lines shall be placed inside any culvert or within 10 feet of the closest point of same.
6. Parallel lines will be installed as near the right-of-way lines as is possible and no parallel line will be installed in the roadbed or between the drainage ditch and roadbed unless approved by the County Engineer in writing.
7. Overhead lines will have a minimum clearance of 18 feet above the road surface at point of crossing.
8. Operations along roadways shall be performed in such a manner that all excavated material be kept off the pavements at all times, as well as all operating equipment and materials. Do not use equipment or installation procedures which will damage any road surface or structure. The cost of any repairs to road surfaces, roadbed, structures or other right-of-way features as direct result of this installation will be borne by the owner of this line.
9. Barricades, warning signs, lights and flagmen, when necessary, shall be provided by the contractor or owner. One half of the traveled portion of the road must be open to traffic at all times. All traffic control shall be in accordance with the requirements of the current version of the Texas MUTCD.
10. Utility company shall install adequate erosion control measures for any excavation work being performed.

APPROVED: _____

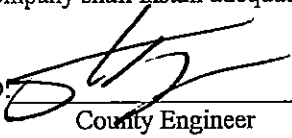
County Engineer

APPROVED: _____

Chairperson, Upshur County Commissioners Court

NOTICE OF PROPOSED INSTALLATION
NOTICE OF PROPOSED INSTALLATION

NOTICE OF PROPOSED INSTALLATION
PIPE AND/OR UTILITY LINES

DATE: 03/28/2022

TO: UPSHUR COUNTY COMMISSIONERS COURT
c/o UPSHUR COUNTY ENGINEER
UPSHUR COUNTY ROAD & BRIDGE DEPARTMENT
P. O. BOX 730
Gilmer, TX 75644

EXPIRES: _____

Frontier Communications utility
Formal notice is hereby given that _____ proposes to bore a _____ line within the right-of-way of County Road _____ as follows: 208 N Dean St., Payette Dr., and Short Oak Dr.

Frontier Communications proposes to bore and place 2981' of (1)-25" duct, place (3) new 17"x30" HHs, and (8) new 2'x3' HHs.

The location and description of the proposed line and appurtenances is more fully shown by three copies of drawings attached to this notice. The line will be constructed and maintained on the County right-of-way as directed by the County Engineer in accordance with current Upshur County specifications.

Construction of this line will begin on or after the 28 day of April, 20 22 and will be completed within 90 days of the date of approval.

Firm CHC Consulting
By Brittany Bruneau
Title Permit Coordinator
Address 9095 Rio San Diego Drive STE 450, San Diego, CA 92108

- NOTE: 1. This form to be submitted in triplicate for each proposed installation.
2. The permit shall be in effect until the utility line is removed from the right of way.
3. Inform the County Engineer if work is not completed within this time.



**FRONTIER COMMUNICATION
CONSTRUCTION SPECIFICATIONS**

- Contact Frontier Engineer CORY RIGGS at (310) 210-9882 sixty (60) days prior to need of service in order to confirm compliance, order materials, and schedule work forces. NOTE: FRONTIER COMMUNICATIONS, INCORPORATED, RESERVES THE RIGHT TO REFUSE ANY CONDUIT, PULL BOXES, MANHOLES, OR UTILITY BOXES THAT DEVIATE FROM PLANS AND SPECIFICATIONS.
- All conduit riser bonds to have a minimum thirty-six (36) inch radius.
- All horizontal ninety (90) degree bends shall have a minimum radius of 12.5 feet and all vertical ninety (90) degree bends shall have a minimum radius of three feet. No more than two ninety (90) degree horizontal bends shall be placed in any single run unless otherwise specified. Contact the Frontier engineer concerning any required deviations.
- All conduit must be proven using a mandrel no less than a 1/2" smaller than the conduit placed. Wall to wall measurements must be taken with a measured tape and a 3/8" polypropylene pull rope in each duct. An accurate wall to wall measurement of conduit placed must be As-built on an approved Frontier construction plan. A copy of the As-built conduit work order must be provided to the Frontier Inspector assigned to your project.
- Place weatherproof caps on all terminated conduits.
- Approved plastic conduit (PVC Sch. 40, TYPE-C or HDPE (2") is to be used in underground construction unless otherwise specified.
- Conduit terminated on a pole must be PVC Sch. 80. Location of riser on pole will be called out by engineering on the construction plan.
- Conduit placed in same trench with primary power conduit must be separated by a minimum of twelve (12) inches of well-packed sand or three inches of concrete, and have a minimum of thirty-six (36) inches of cover when placed behind curb face. All street crossings and conduits placed in the driven portion of the roadway must have a minimum of forty-eight (48) inches of cover to top of pipe. CONTACT THE FRONTIER INSPECTOR 48 HOURS BEFORE TRENCHING AND UPON COMPLETION OF YOUR SUBSTRUCTURES TO SCHEDULE THE FINAL INSPECTION.

**PERMITTING AGENCY:
UPSHUR COUNTY**

PICK UP POINT:
NEW HH

PATH FOOTAGE:
BORE = 2881'

MATERIALS:
(3) NEW 17'X30" HH
(8) NEW 2'X3' HH
2881' OF (1)-1.25" DUCT



**Know what's below.
Call before you dig.**

CONSTRUCTION PACKAGE

**208 N DEAN ST,
PYEATT DR & SHORT OAK DR
GLADEWATER, TX 75647**

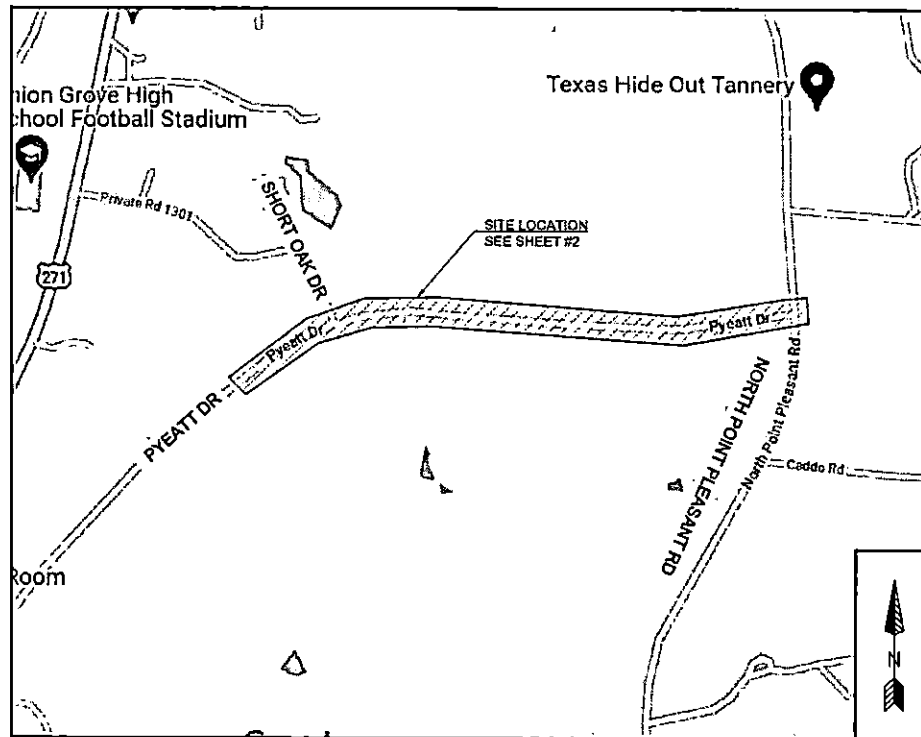

VICINITY MAP
NTS

-HDPE AND PVC FOOTAGES DO NOT INCLUDE SWEEPS
-ACTUAL FOOTAGES OF HDPE AND PVC WILL BE NEEDED TO ORDER MATERIALS. PLEASE INCLUDE MEASURED TAPE IN ALL PVCS.
-FRONTIER INSPECTOR SHALL BE PRESENT ON SITE WHEN CONTRACTOR NEEDS TO ACCESS ANY EXISTING FRONTIER FACILITY.

ABBREVIATIONS

BLDG	BUILDING	FED	PEDESTAL (UTILITY)
C/L	CENTER LINE	PVC	POLYVINYL CHLORIDE
CONC	CONCRETE	P/L	PROPERTY LINE
CSW	CONCRETE SIDEWALK	RR	RAILROAD
DWY	DRIVEWAY	R/W	RIGHT OF WAY
EOC	EDGE OF CURB	SL	STREET LIGHT
EOP	EDGE OF PAVEMENT	W-BLDG	WALL TO BUILDING
ETW	ETW LINE	W-P	WALL TO POLE
HH	HANDHOLE	W-W	WALL TO WALL
MH	MANHOLE	P.U.E	PUBLIC UTILITY EASEMENT
NTS	NOT TO SCALE	P.S.E	PUBLIC SERVICE EASEMENT
		C/G	CURB & GUTTER

LEGEND

	New Trench
	New Bore
	Existing Gas
	Existing Water
	Existing Telephone
	Existing Sewer
	Existing Storm Drain
	Existing Electric
	Existing Manhole
	Existing Handhole (2'x3' or 17"x30")
	DSLAM
	X-CONNECT
	POWER PEDESTAL
	TELCO PEDESTAL
	3' X 5' PULL BOX
	POLE

**Frontier
COMMUNICATIONS**

JOB ID: 5291572 DATE: 01/08/2022
TITLE: 208 N DEAN ST
STREET ADDRESS: PYEATT DR
CITY/STATE: GLADEWATER, TX 75647 (UPSHUR COUNTY)
FTR ENGINEER: CORY RIGGS (310) 210-9882
FTR INSPECTOR: JAMES WEST (972) 578-3224

CHC CONSULTING
DRAWN BY: CHC CONSULTING
EST. #: SHEET#: 1 OF 7



Know what's below.
Call before you dig.

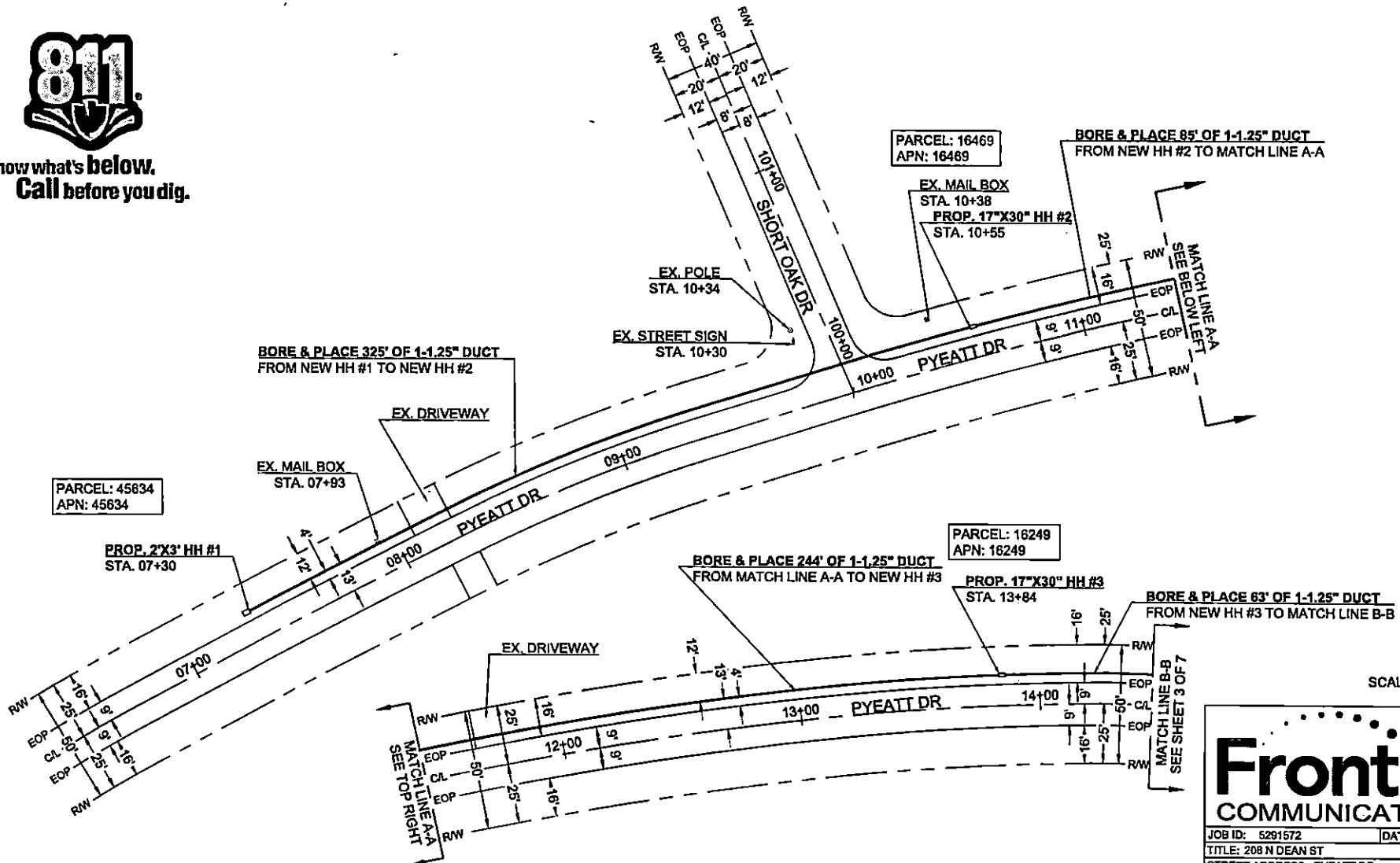

SCALE: 1"=40'

Frontier COMMUNICATIONS

JOB ID: 5291572 DATE: 01/08/2022

TITLE: 208 N DEAN ST

STREET ADDRESS: PYEATT DR

CITY/STATE: GLADEWATER, TX 75847 (UPSHUR COUNTY)

FTR ENGINEER: CORY RIGGS (310) 210-9882

FTR INSPECTOR: JAMES WEST (872) 578-3224

CHC CONSULTING
ENGINEERED BY:
CHC CONSULTING, LLC
808 N.W. 40TH DR. STE 404
DAVENPORT, NC 27834

DRAWN BY:
CHC CONSULTING

EST. #:

SHEET#: 2 OF 7

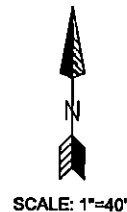
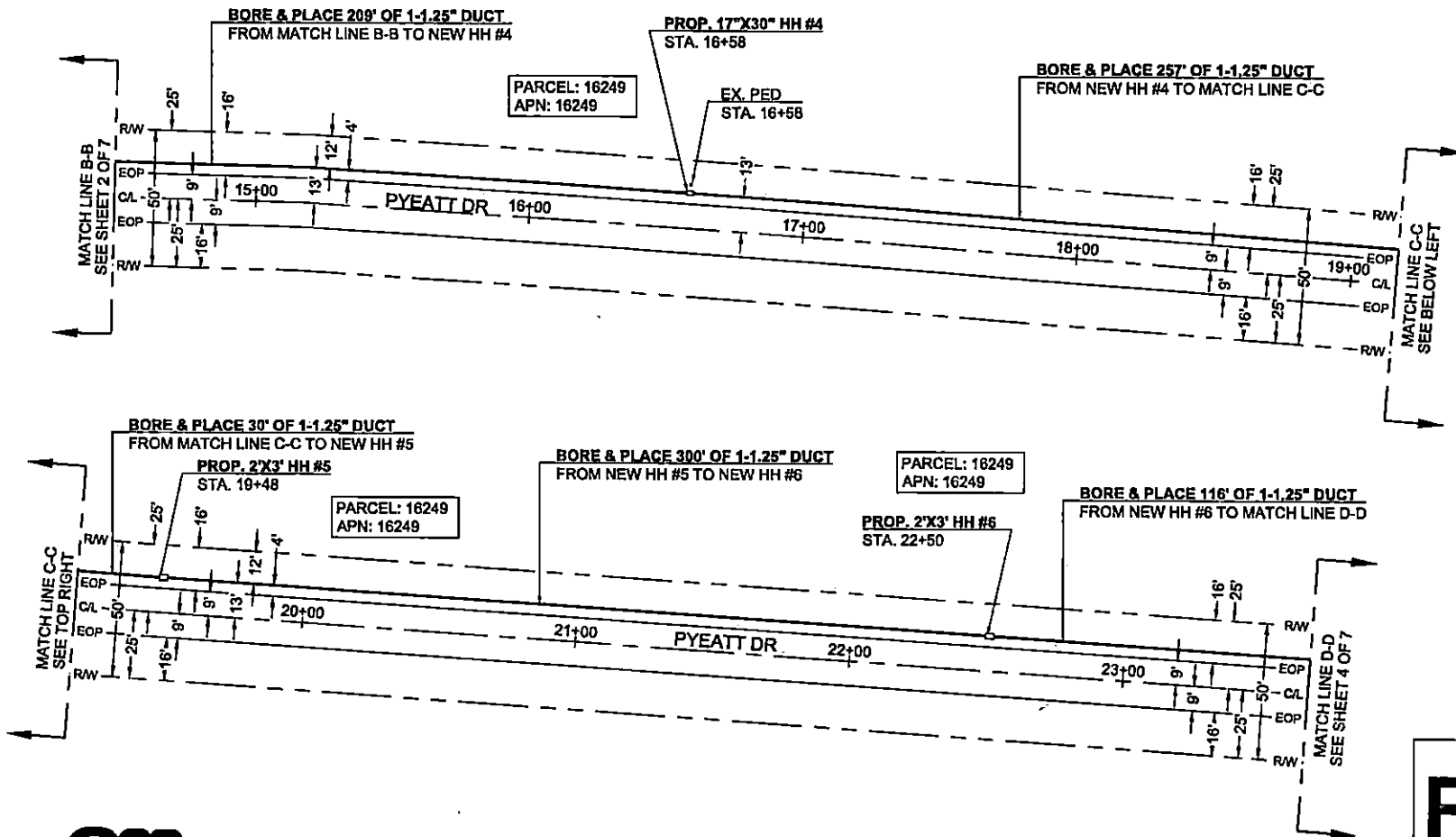

Know what's below.
Call before you dig.

Frontier COMMUNICATIONS

JOB ID: 6291572	DATE: 01/08/2022
TITLE: 208 N DEAN ST	
STREET ADDRESS: PYEATT DR	
CITY/STATE: GLADEWATER, TX 76047(UPSHUR COUNTY)	
FTR ENGINEER: CORY RIGGS (310) 210-9882	
FTR INSPECTOR: JAMES WEST (872) 578-3224	
 CHC CONSULTING <small>ENGINEERED BY: CHC CONSULTING, LLC 8080 W. SAN DIEGO DR. STE 400 SAN DIEGO, CA 92128</small>	DRAWN BY: CHC CONSULTING EST. #: SHEET#:
	3 OF 7

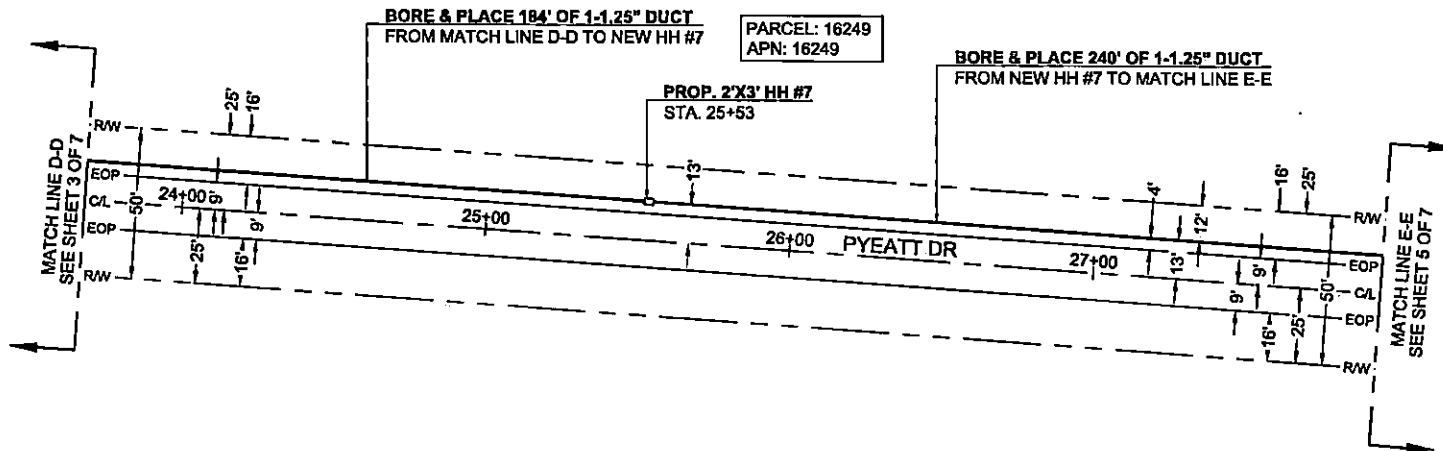

PARCEL: 16249
APN: 16249

PROP. 2'X3' HH #7
STA. 25+53

BORE & PLACE 240' OF 1-1.25" DUCT
FROM NEW HH #7 TO MATCH LINE E-E



SCALE: 1"=40'



Know what's below.
Call before you dig.

Frontier COMMUNICATIONS

JOB ID: 5291572 DATE: 01/08/2022
TITLE: 208 N DEAN ST
STREET ADDRESS: PYEATT DR
CITY/STATE: GLADEWATER, TX 76847(UPSHUR COUNTY)
FTR ENGINEER: CORY RIGGS (310) 210-8882
FTR INSPECTOR: JAMES WEST (972) 578-3224

CHC CONSULTING <small>ENGINEERED BY: CHC CONSULTING, LLC 8008 RIO SAN DIEGO DR, STE 40 SAN DIEGO, CA 92108</small>	DRAWN BY: CHC CONSULTING	EST. #:	SHEET#: 4 OF 7

PARCEL: 16249
APN: 16249

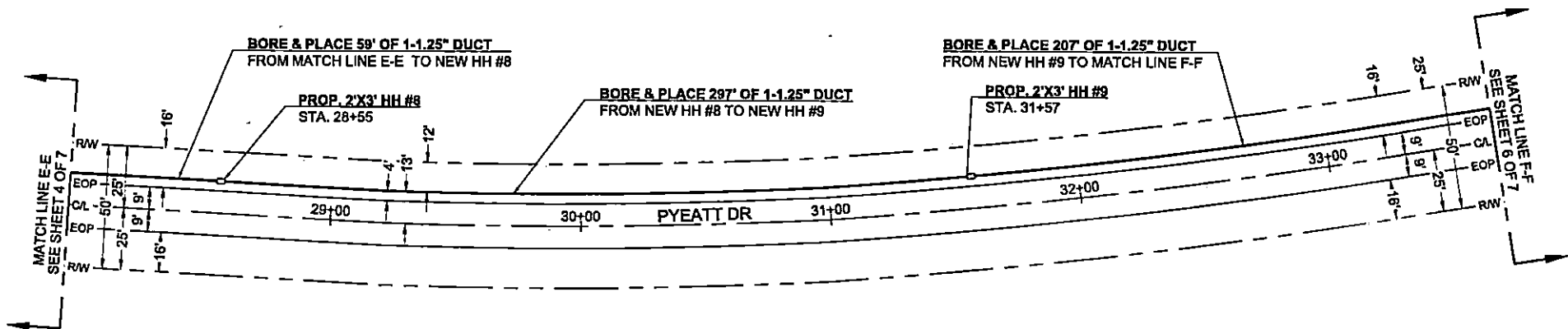

PARCEL: 17442
APN: 17442



SCALE: 1"=40'



Know what's below.
Call before you dig.

Frontier COMMUNICATIONS

JOB ID: 5291572 DATE: 01/06/2022
TITLE: 208 N DEAN ST
STREET ADDRESS: PYEATT DR
CITY/STATE: GLADEWATER, TX 75647(UPSHUR COUNTY)
FTR ENGINEER: CORY RIGGS (310) 210-9882
FTR INSPECTOR: JAMES WEST (872) 578-3224

 CHC CONSULTING ENGINEERED BY: CHC CONSULTING LLC 9000 RIO SAN DIEGO DR, STE 400 SAN DIEGO, CA 92108	DRAWN BY: CHC CONSULTING
	EST. #: SHEET #: 5 OF 7

PARCEL: 17277
APN: 17277

PARCEL: 17217
APN: 17217

PARCEL: 77288
APN: 77288

BORE & PLACE 274' OF 1-1.25" DUCT
FROM NEW HH #10 TO NEW HH #11

PROP. 2'X3' HH #11
STA. 37+35

BORE & PLACE 80' OF 1-1.25" DUCT
FROM MATCH LINE F-F TO NEW HH #10

PROP. 2'X3' HH #10
STA. 34+58

EX. STREET SIGN
STA. 37+64

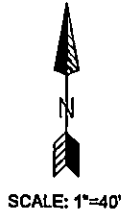
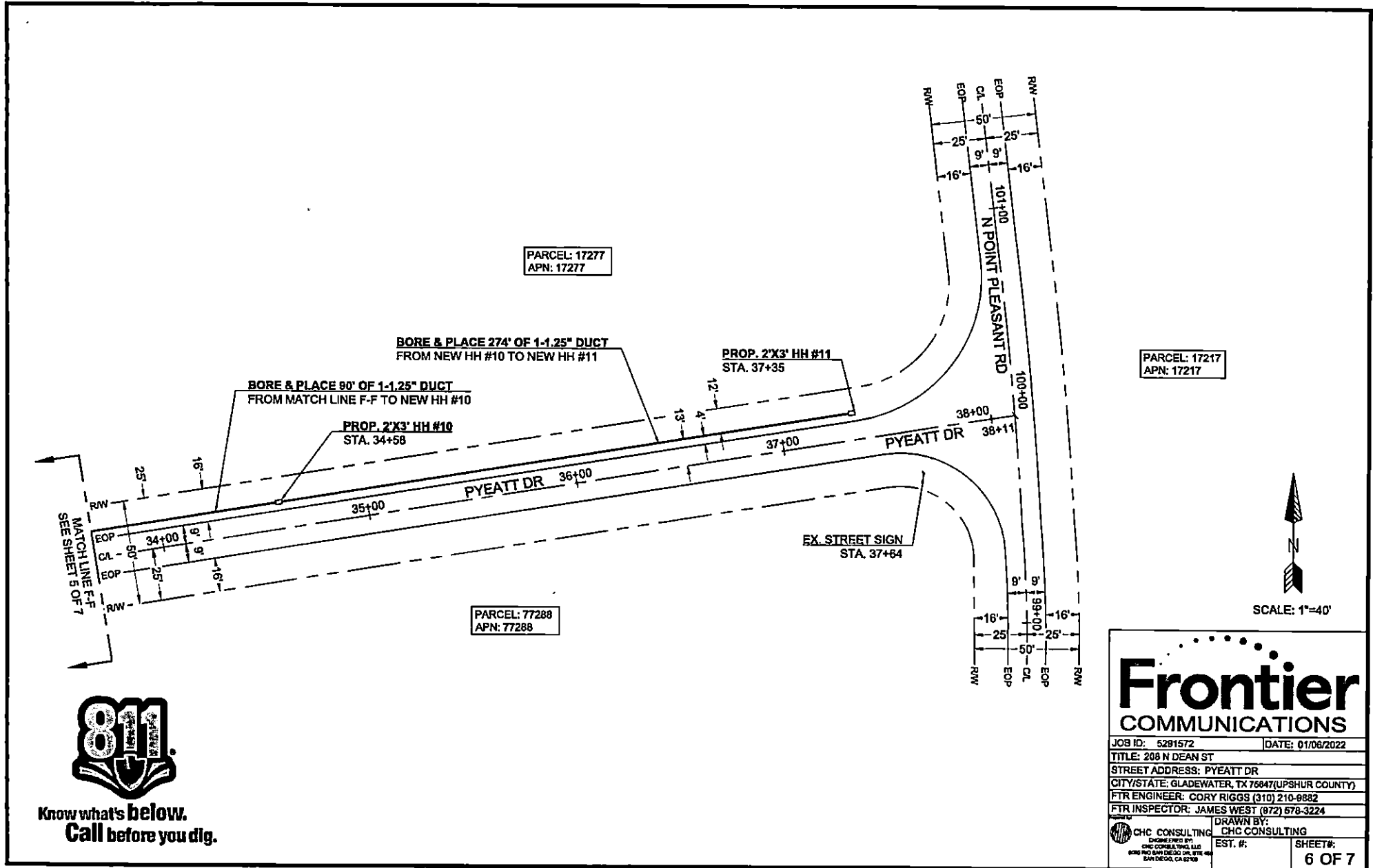

Know what's below.
Call before you dig.

Frontier COMMUNICATIONS

JOB ID: 5291572 DATE: 01/06/2022
 TITLE: 208 N DEAN ST
 STREET ADDRESS: PYEATT DR
 CITY/STATE: GLADEWATER, TX 76047 (UPSHUR COUNTY)
 FTR ENGINEER: CORY RIGGS (310) 210-8882
 FTR INSPECTOR: JAMES WEST (972) 578-3224

CHC CONSULTING <small>ENGINEERED BY: CHC CONSULTING, LLC 8038 MIDWAY DRIVE, SUITE 400 SAN DIEGO, CA 92128</small>	DRAWN BY: CHC CONSULTING EST. #:	SHEET#: 6 OF 7
--	--	-------------------

MINIMUM STANDARDS FOR DIRECTIONAL BORING

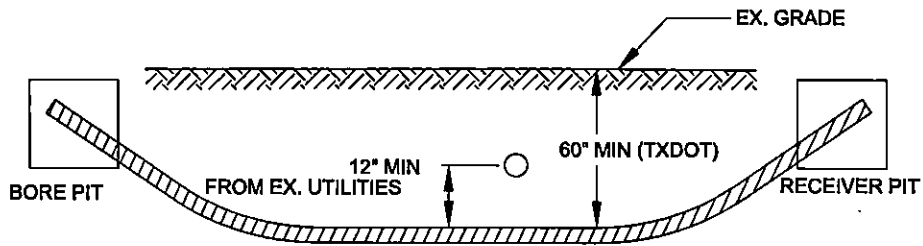

- PLACE END MARKER WITH UTILITY OWNER'S NAME DESCRIBING CONDUIT
- BORE PIT TO BE BACKFILLED AND COMPACTED IN 12" LIFTS WITH MATERIAL REMOVED
- FLOW OF DITCH MUST BE MAINTAINED AT ALL TIMES
- PROTECT ROOTS AT ALL TREE LOCATIONS, SHIFT BORE TRENCH IF NECESSARY

TYPICAL BORE DETAIL

SCALE
N.T.S. 1

JOB ID: 5291572		DATE: 01/08/2022	
TITLE: 208 N DEAN ST			
STREET ADDRESS: PVEATT DR			
CITY/STATE: GLADEWATER, TX 76047(LPSHUR COUNTY)			
FTR ENGINEER: CORY RIGGS (310) 210-8882			
FTR INSPECTOR: JAMES WEST (972) 678-3224			
CHC CONSULTING <small>ENGINEERED BY: CHC CONSULTING, LLC 8880 RIO SAN DIEGO DR, STE 400 SAN DIEGO, CA 92128</small>		DRAWN BY: CHC CONSULTING EST. #: _____ SHEET#:	
		7 OF 7	

PIPE AND/OR UTILITY LINES

DATE: 3/31/2022

TO: UPSHUR COUNTY COMMISSIONERS COURT
c/o UPSHUR COUNTY ENGINEER
UPSHUR COUNTY ROAD & BRIDGE DEPARTMENT
P. O. BOX 730
Gilmer, TX 75644

EXPIRES:6/31/2022

Formal notice is hereby given that Etex Telephone Coop., Inc. proposes to bore a New Fiber Optic line within the right-of-way of County Roads Walker, Shetland, Pomergrante, Mustang, Sorrel, Silver Spruce, Redwood as follows: All construction will be Directional Bored in at a min Depth of 48" on both sides of said roads and on the up side of ditch line with in the county right of way. Installing two 1.25" Duct with a new Fiber Optic Cable.

The location and description of the proposed line and appurtenances is more fully shown by three copies of drawings attached to this notice. The line will be constructed and maintained on the County right-of-way as directed by the County Engineer in accordance with current Upshur County specifications.

Construction of this line will begin on or after the 31 day of March, 2022 and will be completed within 90 days of the date of approval.

Firm Etex Telephone Coop., Inc.
By Martin Thompson
Title Right of way solicitor
Address P.O. Box 130 Gilmer Texas 75644

- NOTE:
1. This form to be submitted in triplicate for each proposed installation.
 2. The permit shall be in effect until the utility line is removed from the right of way.
 3. Inform the County Engineer if work is not completed within this time

APPROVAL

TO: Etex Telephone Coop., Inc
P.O. Box 130
Gilmer Texas 75644

DATE 3/31/2022

The Upshur County Commissioners Court offers no objections to the location on the right-of-way of your proposed New Fiber Optic line across Said Roads as shown by accompanying drawings and notice dated 3/31/2022, except as note N/A

It is expressly understood that the Upshur County Commissioners Court does not purport, hereby, to grant and right, claim, title, or easement in or upon this county road; and it is further understood that in the future should for any reason Upshur County need to work, improve, relocate, widen, increase add to or any manner change the structure of this right-of-way line, this line, if affected, will be moved under the direction of the Upshur County Engineer and shall be relocated at the complete expense of the owner. Upshur County shall be notified a minimum of 48 hours prior to the beginning of any work.

All work on the county right-of-way shall be performed in accordance with the County Engineer's instructions. The installation shall not damage any part of the highway and adequate provisions must be made to cause minimum inconvenience to traffic and adjacent property owners. Special specifications for placing this line are as follows:

1. All ground lines are to be installed a minimum of 36 inches below the flowline of the adjacent drainage or borrow ditch.
2. All excavations within the right-of-way and not under surfacing shall be backfilled by tamping in 6 inch horizontal layers. All surplus material shall be removed from the right-of-way and the excavation finished flush with surrounding natural ground.
3. Lines crossing under surfaced roads and under surfaced cross roads within the right-of-way shall be placed by boring. Boring shall extend from crown line to crown line.
4. All lines under roads carrying pressure in excess of 50 psi shall be enclosed in satisfactory casing extending from right-of-way line to right-of-way line. Pipe used for casing may be of any type approved by the County Engineer and shall be capable of Supporting the load of roadbed and traffic and shall be so constructed that there will be no leakage of any matter through the casing for its entire length. Inside diameter of casing shall be at least 2 inches greater than the largest outside diameter of carrier pipe, joint or couplings. (Encasement is not required on lines installed 48 inches or greater below flowline.)
5. All lines, where practicable, shall be located to cross roadbed at approximately right angles thereto. No lines are to be installed under or within 50 feet of either end of a bridge unless approved by the County Engineer in writing. No lines shall be placed inside any culvert or within 10 feet of the closest point of same.
6. Parallel lines will be installed as near the right-of-way lines as is possible and no parallel line will be installed in the roadbed or between the drainage ditch and roadbed unless approved by the County Engineer in writing.
7. Overhead lines will have a minimum clearance of 18 feet above the road surface at point of crossing.
8. Operations along roadways shall be performed in such a manner that all excavated material be kept off the pavements at all times, as well as all operating equipment and materials. Do not use equipment or installation procedures which will damage any road surface or structure. The cost of any repairs to road surfaces, roadbed, structures or other right-of-way features as direct result of this installation will be borne by the owner of this line.
9. Barricades, warning signs, lights and flagmen, when necessary, shall be provided by the contractor or owner. One half of the traveled portion of the road must be open to traffic at all times. All traffic control shall be in accordance with the requirements of the current version of the Texas MUTCD.
10. Utility company shall install adequate erosion control measures for any excavation work being performed.

APPROVED: 
County Engineer

APPROVED: _____
Chairperson, Upshur County Commissioners Court

NOTICE OF PROPOSED INSTALLATION
NOTICE OF PROPOSED INSTALLATION

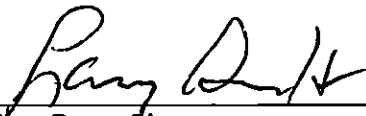

First Party Signature
Larry Gaudet

P.O. Box 668, 3311 Suebell Lake Road

Street or Box

Marshall, TX 75670

City, State and Zip Code

903-938-9221

Telephone

Barnwell

Timber Tract / Property Owner

Issued by Annette M. Norton, Valid April 5, 2022 to July 5, 2022

PERMIT ISSUED NOT TO EXCEED 90 DAYS UNLESS OTHERWISE NOTED

A COPY OF THIS PERMIT MUST BE IN EVERY TRUCK BEING USED

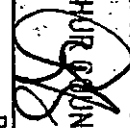
FILED
TERRI ROSS
COUNTY CLERK
2022 APR 14 PM 1:06
UPSHOIR COUNTY, TX.
BY 
DEPUTY